

DRIVELINE/AXLE

03
SECTION

GENERAL PROCEDURES	03-10	DRIVE SHAFT	03-13
FRONT AXLE	03-11	TECHNICAL DATA	03-50
REAR AXLE	03-12	SERVICE TOOLS	03-60

03-10

03-10 GENERAL PROCEDURES

PRECAUTION (DRIVELINE/AXLE)	03-10-1	Suspension Arm	
Wheel and Tire Removal/Installation . .	03-10-1	Removal/Installation	03-10-1
Brake Line			
Disconnection/Connection	03-10-1		

PRECAUTION (DRIVELINE/AXLE)

A3U031001018W01

Wheel and Tire Removal/Installation

1. The removal and installation procedures for the wheels and tires are not mentioned in this section. When a wheel is removed, tighten it to **89—117 N·m {9.0—12.0 kgf·m, 65.1—86.7 ft·lbf}**.

Brake Line Disconnection/Connection

Caution

- **Brake fluid will damage painted surfaces. If brake fluid gets on a painted surface, wipe it off immediately.**

1. Tighten the brake pipe flare nut using the **SST** (49 0259 770B). Be sure to modify the brake pipe flare nut tightening torque to allow for use of a torque wrench-**SST** combination. (See 00-00-15 Torque Formulas.)
 - If any brake line has been disconnected any time during the procedure, add brake fluid, bleed the brakes, and inspect for leakage after the procedure has been completed.

Suspension Arm Removal/Installation

1. Tighten any part of the suspension that uses rubber bushings only after vehicle has been lowered and unloaded.

Note

- Unloaded ... Fuel tank is full. Engine coolant and engine oil are at specified level. Spare tire, jack, and tools are in designated position.

03-11 FRONT AXLE

FRONT AXLE LOCATION INDEX 03-11-1

WHEEL HUB, STEERING KNUCKLE

PRE-INSPECTION 03-11-1

 Wheel Bearing Play Inspection 03-11-1

WHEEL HUB BOLT REPLACEMENT .. 03-11-2

WHEEL HUB, STEERING KNUCKLE

REMOVAL/INSTALLATION 03-11-3

 Locknut Removal Note 03-11-4

 Wheel Hub Component

 Removal Note 03-11-4

Wheel Bearing Removal Note 03-11-4

Dust Cover Removal Note 03-11-5

Hub Bolt Removal Note 03-11-5

Hub Bolt Installation Note 03-11-5

Dust Cover Installation Note 03-11-6

Wheel Bearing Installation Note 03-11-6

Wheel Hub Component

 Installation Note 03-11-6

Oil Seal Installation Note 03-11-7

Locknut Installation Note 03-11-7

03-11

FRONT AXLE LOCATION INDEX

A3U031104000W01

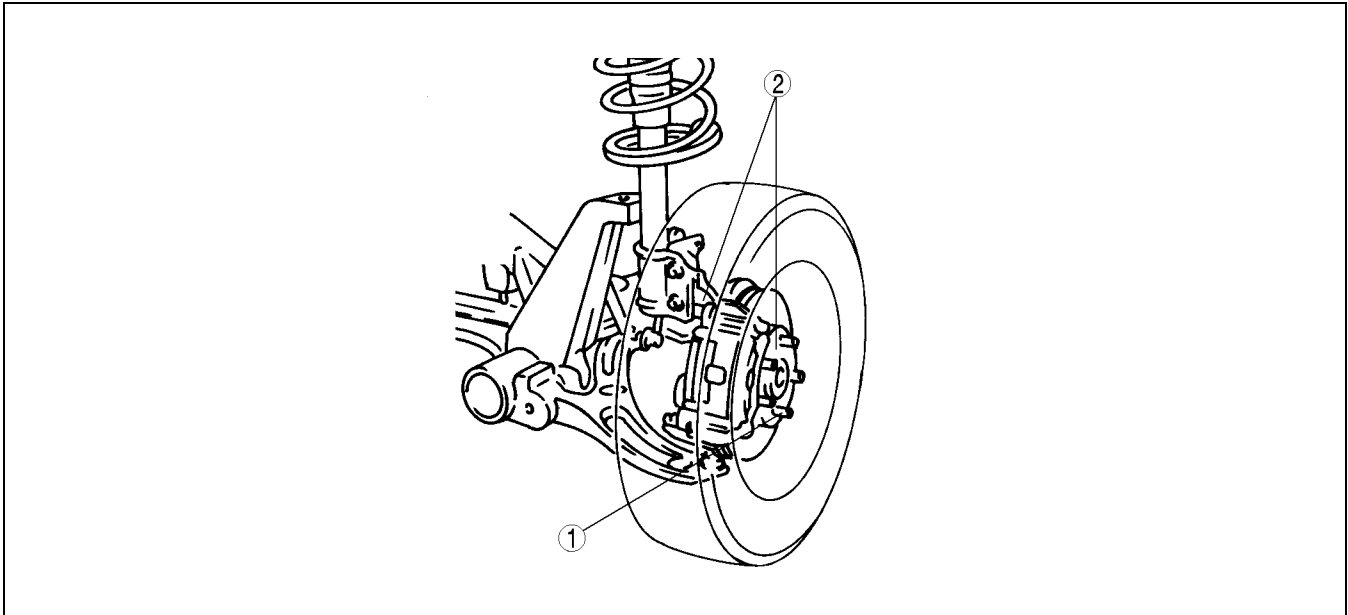

Z3U0311W001

1	Hub bolt (See 03-11-2 WHEEL HUB BOLT REPLACEMENT)
---	--

2	Wheel hub, steering knuckle (See 03-11-3 WHEEL HUB, STEERING KNUCKLE REMOVAL/INSTALLATION) (See 03-11-1 WHEEL HUB, STEERING KNUCKLE PRE-INSPECTION)
---	---

WHEEL HUB, STEERING KNUCKLE PRE-INSPECTION

A3U031104000W02

Wheel Bearing Play Inspection

1. Position a dial indicator against the wheel hub.
2. Push and pull the wheel hub by hand in the axial direction and measure the wheel bearing play.
 - If the bearing play exceeds the specification, replace the wheel bearing as necessary and tighten the locknut to the specified torque and retest.

Maximum wheel bearing play
0.05 mm {0.002 in}

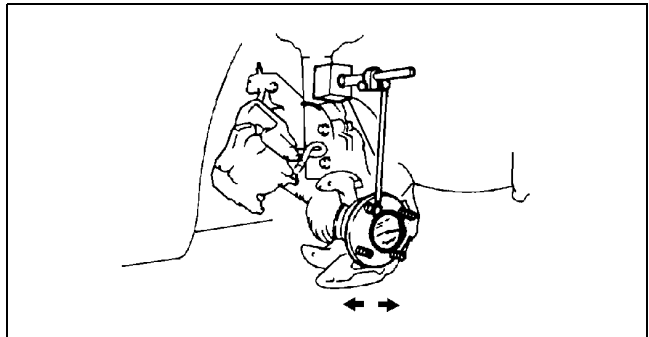

A3U0311W010

FRONT AXLE

WHEEL HUB BOLT REPLACEMENT

A3U031104000W03

1. Remove the hub bolt using the **SSTs**.

Note

- If the dust cover interferes with the wheel hub bolt and the wheel hub bolt cannot be removed, tap the part shown in the figure with a chisel lightly and bend the processing point back to the steering knuckle side.

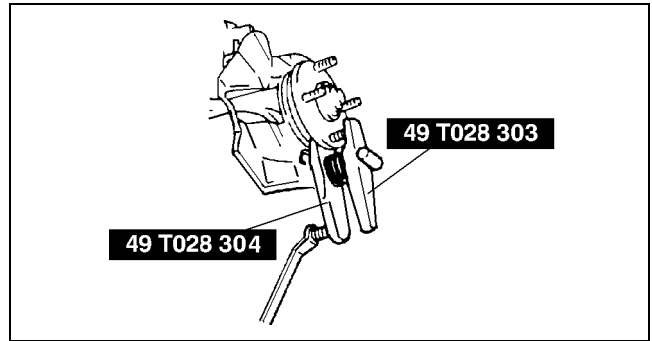

A3U0311W007

2. Install the hub bolt into the wheel hub and install a washer and hub nut on the hub bolt.

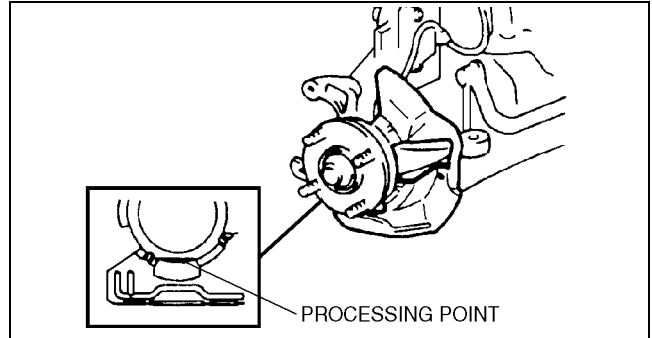

A3U0311W002

3. Tighten the hub nut while holding the wheel hub using a brass bar.

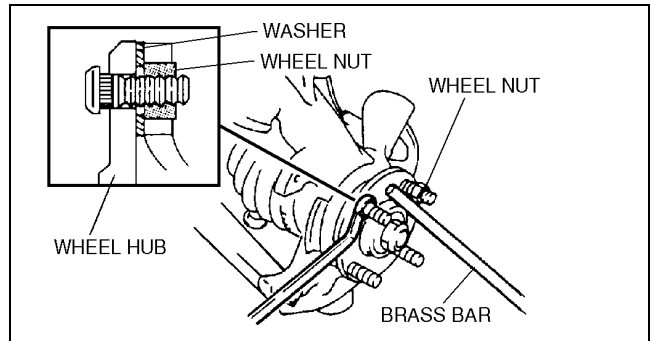

A3U0311W003

FRONT AXLE

WHEEL HUB, STEERING KNUCKLE REMOVAL/INSTALLATION

A3U03110400W04

Caution

- Performing the following procedures without first removing the ABS wheel-speed sensor may possibly cause an open circuit in the harness if it is pulled by mistake. Before performing the following procedures, remove the ABS wheel-speed sensor (axle side) and fix it to an appropriate place where the sensor will not be pulled by mistake while servicing the vehicle.

- Remove in the order indicated in the table.
- Install in the reverse order of removal.
- After installation, inspect the front wheel alignment. (See 02-11-1 FRONT WHEEL ALIGNMENT.)

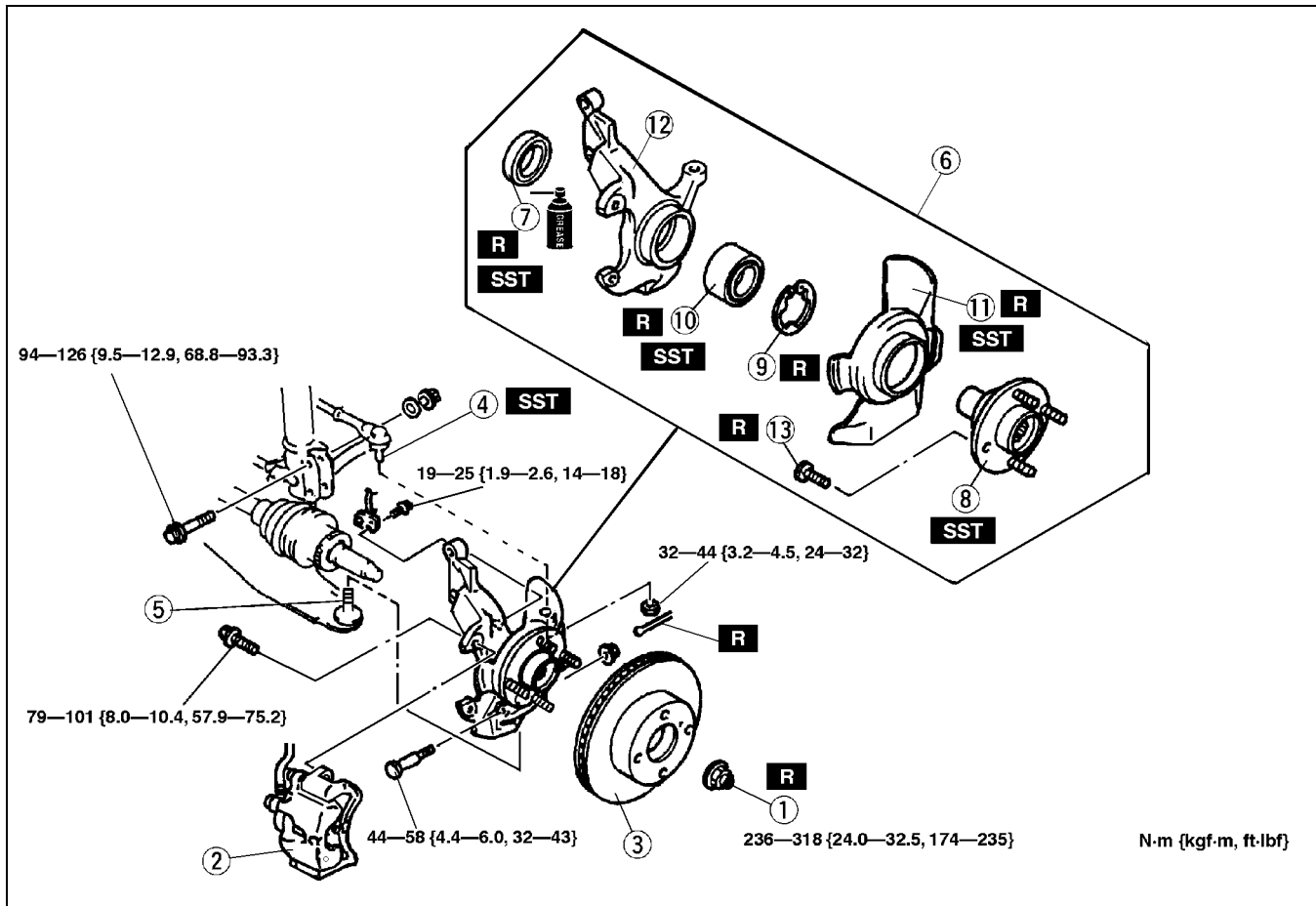

A3U0311W001

1	Locknut (See 03-11-4 Locknut Removal Note) (See 03-11-7 Locknut Installation Note)
2	Brake caliper component
3	Disc plate
4	Tie-rod end (See 06-12-10 Tie-rod End Ball Joint Removal Note)
5	Lower arm ball joint
6	Wheel hub, steering knuckle, dust cover
7	Oil seal (See 03-11-7 Oil Seal Installation Note)
8	Wheel hub component (See 03-11-4 Wheel Hub Component Removal Note) (See 03-11-6 Wheel Hub Component Installation Note)

9	Retaining ring
10	Wheel bearing (See 03-11-4 Wheel Bearing Removal Note) (See 03-11-6 Wheel Bearing Installation Note)
11	Dust cover (See 03-11-5 Dust Cover Removal Note) (See 03-11-6 Dust Cover Installation Note)
12	Steering knuckle
13	Hub bolt (See 03-11-5 Hub Bolt Removal Note) (See 03-11-5 Hub Bolt Installation Note)

03-11

FRONT AXLE

Locknut Removal Note

1. Knock the crimped portion of the locknut outward using a small chisel and a hammer.
2. Lock the hub by applying the brakes.
3. Remove the locknut.

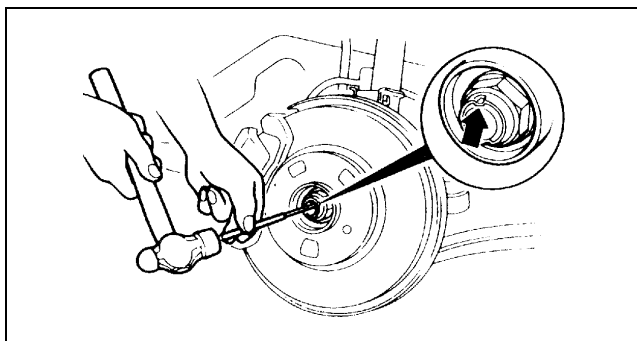

X3U311WA5

Wheel Hub Component Removal Note

1. Remove the wheel hub component using the SSTs.

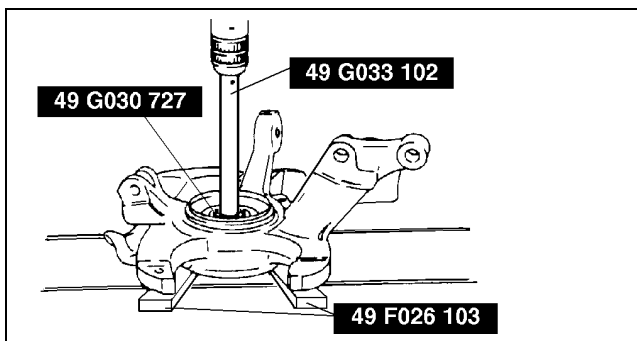

A3U0311W008

2. If the bearing inner race remains on the front wheel hub component, grind a section of the bearing inner race until **approx. 0.5 mm {0.020 in}** remains. Then remove it using a chisel.

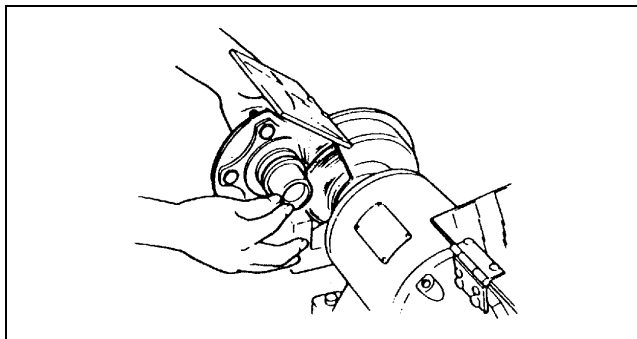

X3U311WA7

Wheel Bearing Removal Note

1. Remove the wheel bearing using the SSTs.

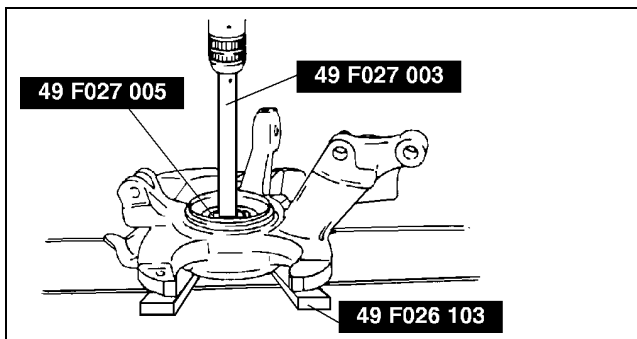

A3U0311W009

FRONT AXLE

Dust Cover Removal Note

Note

- The dust cover does not need to be removed unless it is being replaced.

1. Mark the dust cover and steering knuckle for proper installation.

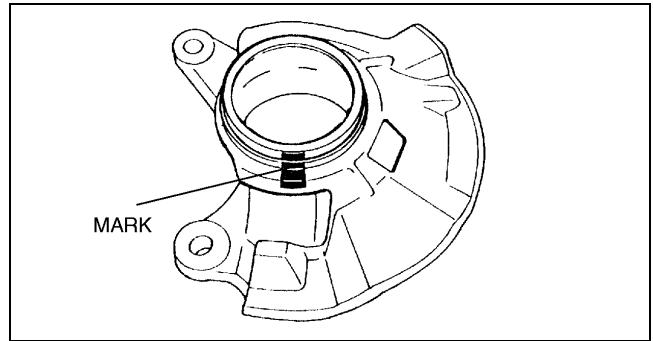

Y3U311WA1

03-11

2. Remove the dust cover using a chisel.

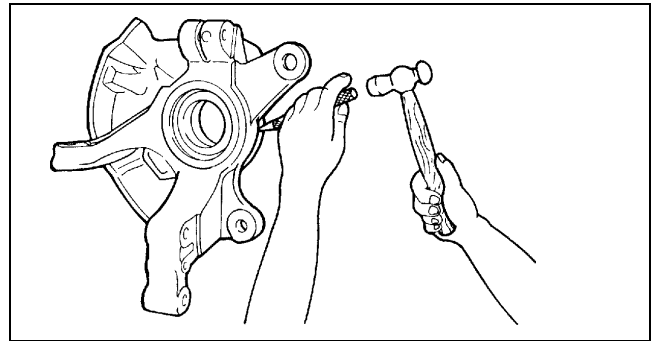

X3U311WAA

Hub Bolt Removal Note

Note

- The hub bolts do not need to be removed unless they are being replaced.

1. Remove the hub bolts using a press.

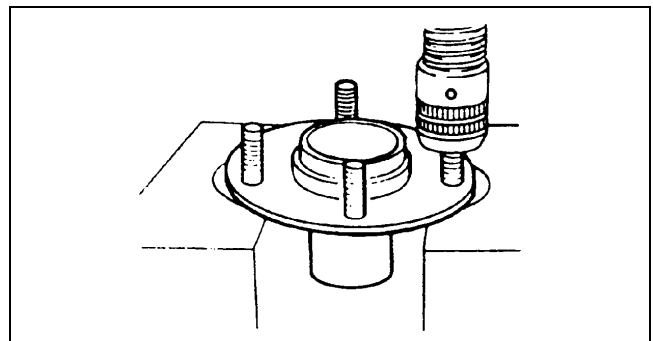

X3U311WAB

Hub Bolt Installation Note

1. Install the new hub bolts using a press.

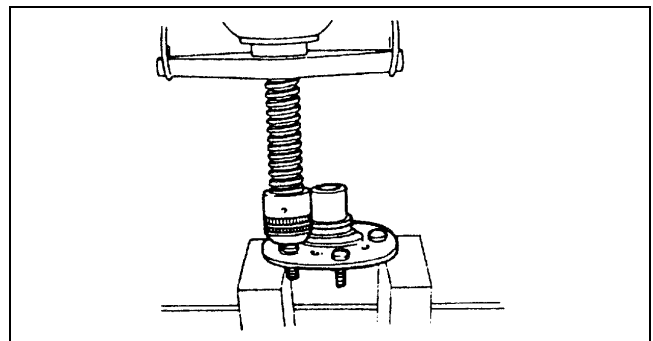

X3U311WAC

FRONT AXLE

Dust Cover Installation Note

1. Mark the new dust cover in the same way as the removed one.
2. Align the marks of the new dust cover and the knuckle.

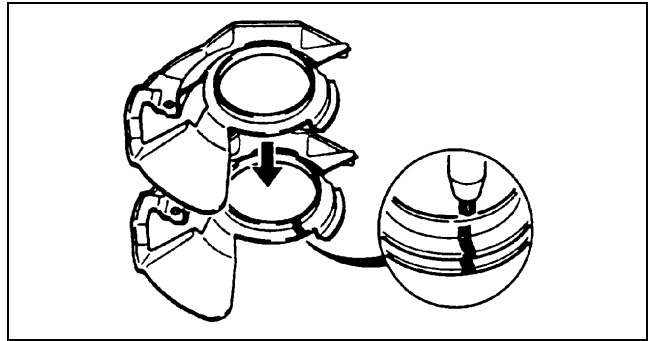

X3U311WAD

3. Install the new dust cover using the SSTs.

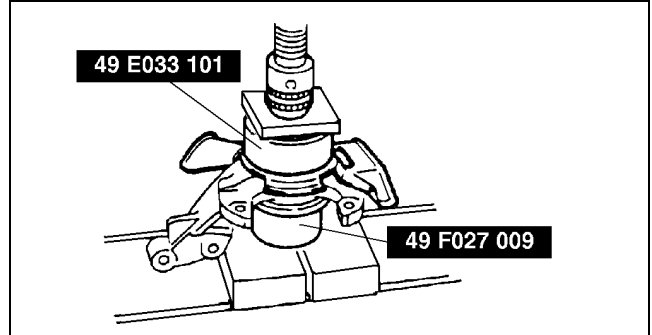

A3U0311W004

Wheel Bearing Installation Note

1. Install the new wheel bearing using the SSTs.

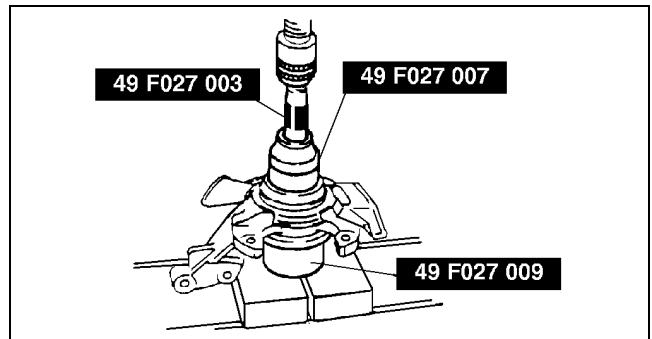

A3U0311W005

Wheel Hub Component Installation Note

1. Install the wheel hub component using the SST.

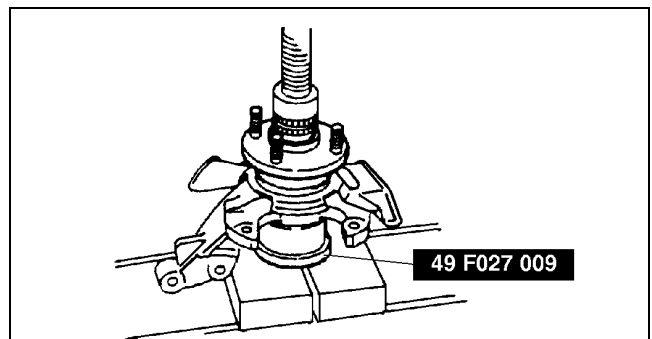

A3U0311W006

FRONT AXLE

Oil Seal Installation Note

1. Apply grease to the new oil seal lip.
2. Install the new oil seal flush with the knuckle using the **SST**.

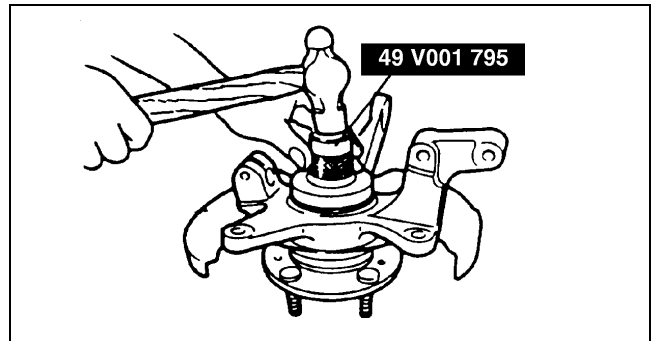

X3U31WAH

03-11

Locknut Installation Note

1. Install a new locknut and stake it as shown.

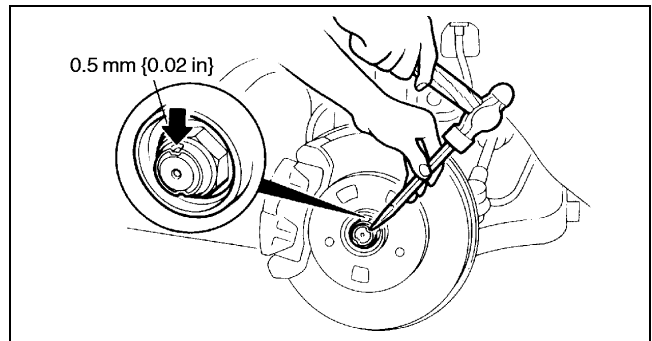

X3U31WAJ

03-12 REAR AXLE

REAR AXLE LOCATION INDEX..... 03-12-1

WHEEL HUB, HUB SPINDLE

PRE-INSPECTION 03-12-1

Wheel Bearing Play Inspection 03-12-1

WHEEL HUB, HUB SPINDLE (DRUM BRAKE TYPE)

REMOVAL/INSTALLATION 03-12-2

Locknut Removal Note..... 03-12-3

ABS Sensor Rotor (With ABS) Removal Note 03-12-3

ABS Sensor Rotor (With ABS) Installation Note03-12-3

Locknut Installation Note03-12-4

WHEEL HUB, HUB SPINDLE (DISC BRAKE TYPE)

REMOVAL/INSTALLATION.....03-12-4

ABS Sensor Rotor (With ABS) Installation Note03-12-5

03-12

REAR AXLE LOCATION INDEX

A3U031205000W01

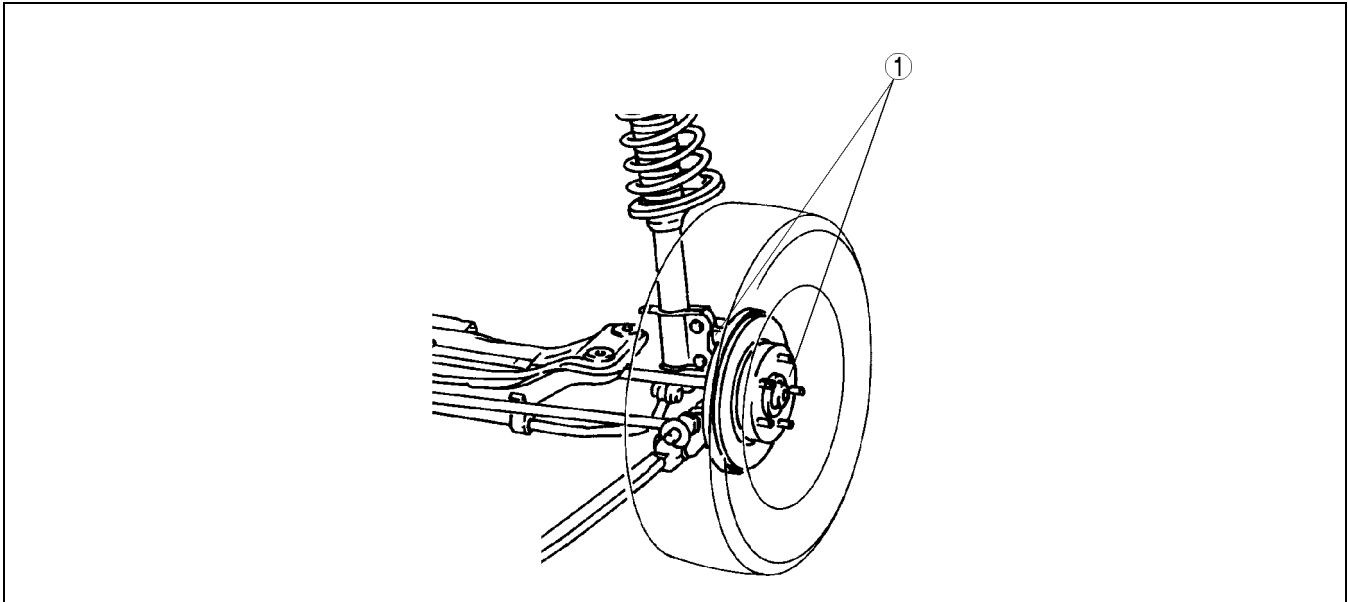

Z3U0312W005

1	Wheel hub, hub spindle (See 03-12-1 WHEEL HUB, HUB SPINDLE PRE-INSPECTION) (See 03-12-4 WHEEL HUB, HUB SPINDLE (DISC BRAKE TYPE) REMOVAL/INSTALLATION) (See 03-12-2 WHEEL HUB, HUB SPINDLE (DRUM BRAKE TYPE) REMOVAL/INSTALLATION)
---	---

WHEEL HUB, HUB SPINDLE PRE-INSPECTION

A3U031205000W02

Wheel Bearing Play Inspection

1. Position a dial indicator against the brake drum (brake drum type), or wheel hub (disc brake type).
2. Push and pull the rear brake component by hand in the axial direction and measure the wheel bearing play.
 - If the bearing play exceeds the specification, replace the wheel hub component as necessary and tighten the locknut to the specified torque and retest.

Wheel bearing play
0.05 mm {0.002 in}

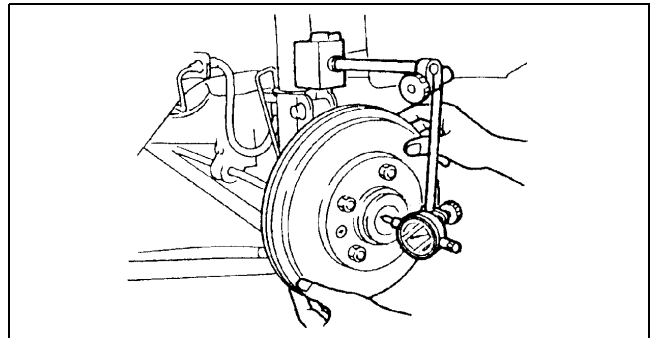

X3U312WA0

REAR AXLE

WHEEL HUB, HUB SPINDLE (DRUM BRAKE TYPE) REMOVAL/INSTALLATION

A3U031205000W03

Caution

- Performing the following procedures without first removing the ABS wheel-speed sensor may possibly cause an open circuit in the harness if it is pulled by mistake. Before performing the following procedures, remove the ABS wheel-speed sensor (axle side) and fix it to an appropriate place where the sensor will not be pulled by mistake while servicing the vehicle.

- Remove in the order indicated in the table.
- Install in the reverse order of removal.

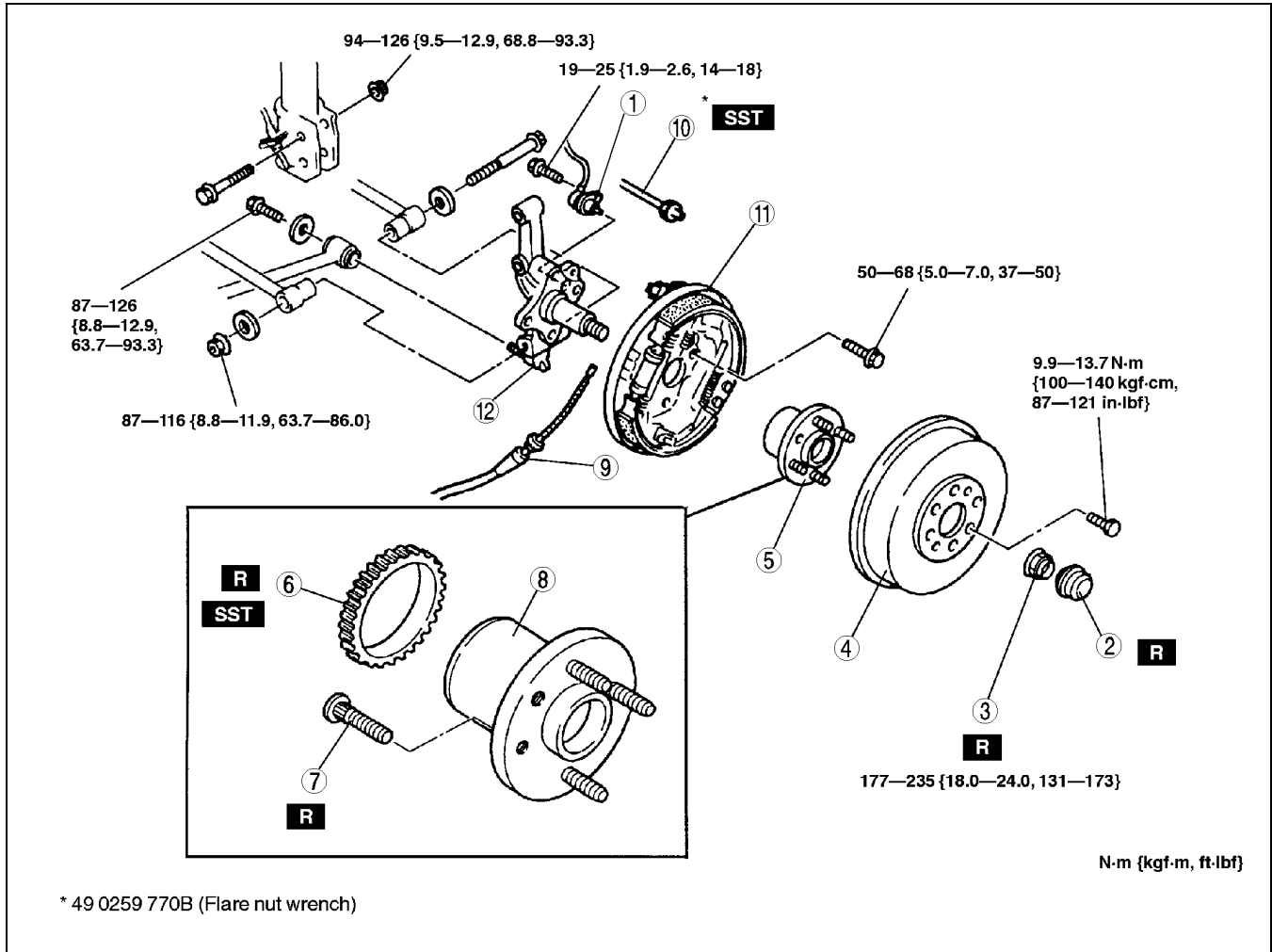

Z3U0312W001

1	ABS-wheel speed sensor
2	Hub cap
3	Locknut (See 03-12-3 Locknut Removal Note) (See 03-12-4 Locknut Installation Note)
4	Brake drum
5	Wheel hub and ABS sensor rotor (with ABS)
6	ABS sensor rotor (with ABS) (See 03-12-3 ABS Sensor Rotor (With ABS) Removal Note) (See 03-12-3 ABS Sensor Rotor (With ABS) Installation Note)

7	Hub bolt (See 03-11-5 Hub Bolt Removal Note) (See 03-11-5 Hub Bolt Installation Note)
8	Wheel hub
9	Parking brake cable
10	Brake pipe
11	Rear brake component
12	Hub spindle

REAR AXLE

Locknut Removal Note

1. Raise the staked portion of the locknut using a small cape chisel and a hammer.
2. Lock the hub by applying the brakes.
3. Remove the locknut.

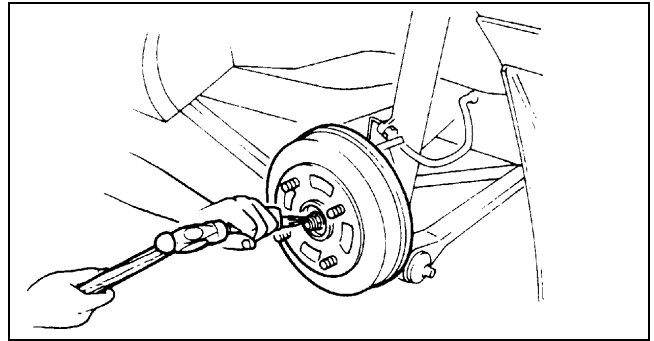

X3U312WA2

03-12

ABS Sensor Rotor (With ABS) Removal Note

Note

- The sensor rotor does not need to be removed unless it is being replaced.

1. Remove the sensor rotor using a chisel.

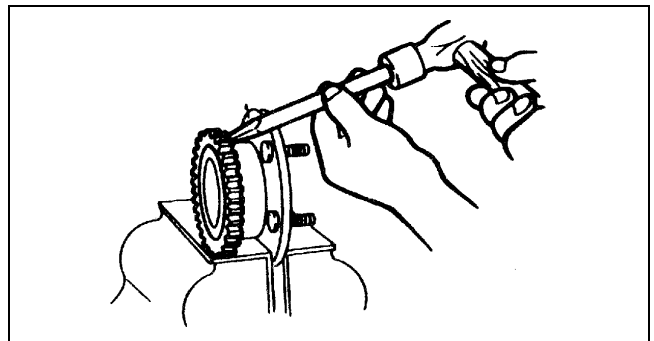

X3U312WA3

ABS Sensor Rotor (With ABS) Installation Note

1. Set the **SST** as shown in the figure.

Caution

- Position the **SST** so that marking **A** faces the bottom.

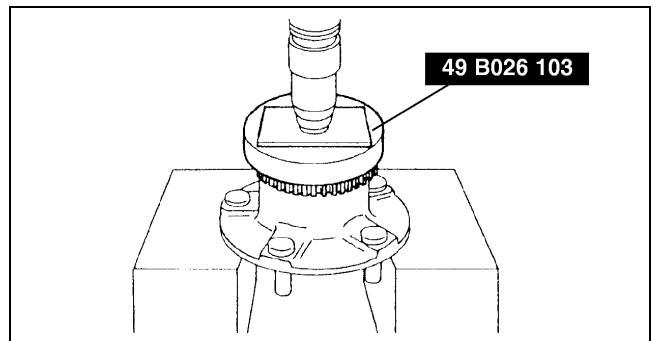

X3U312WA4

2. Press on the new sensor rotor using the **SST** and a press.

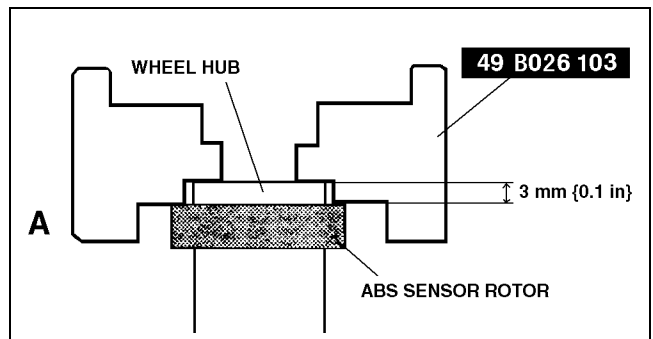

A3U0312W003

REAR AXLE

Locknut Installation Note

1. Install a new locknut and stake it as shown.

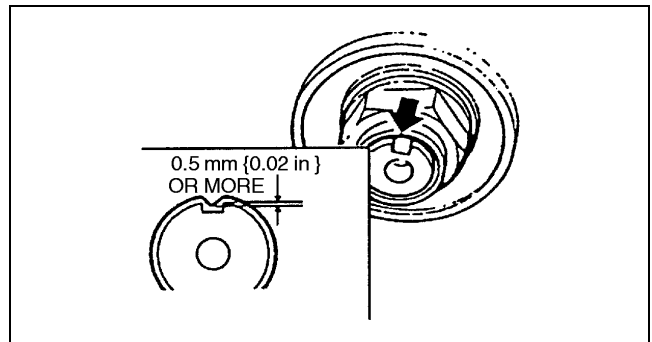

X3U312WA5

WHEEL HUB, HUB SPINDLE (DISC BRAKE TYPE) REMOVAL/INSTALLATION

A3U031205000W04

Caution

- Performing the following procedures without first removing the ABS wheel-speed sensor may possibly cause an open circuit in the harness if it is pulled by mistake. Before performing the following procedures, remove the ABS wheel-speed sensor (axle side) and set it to an appropriate place where the sensor will not be pulled by mistake while servicing the vehicle.

1. Remove in the order indicated in the table.
2. Install in the reverse order of removal.

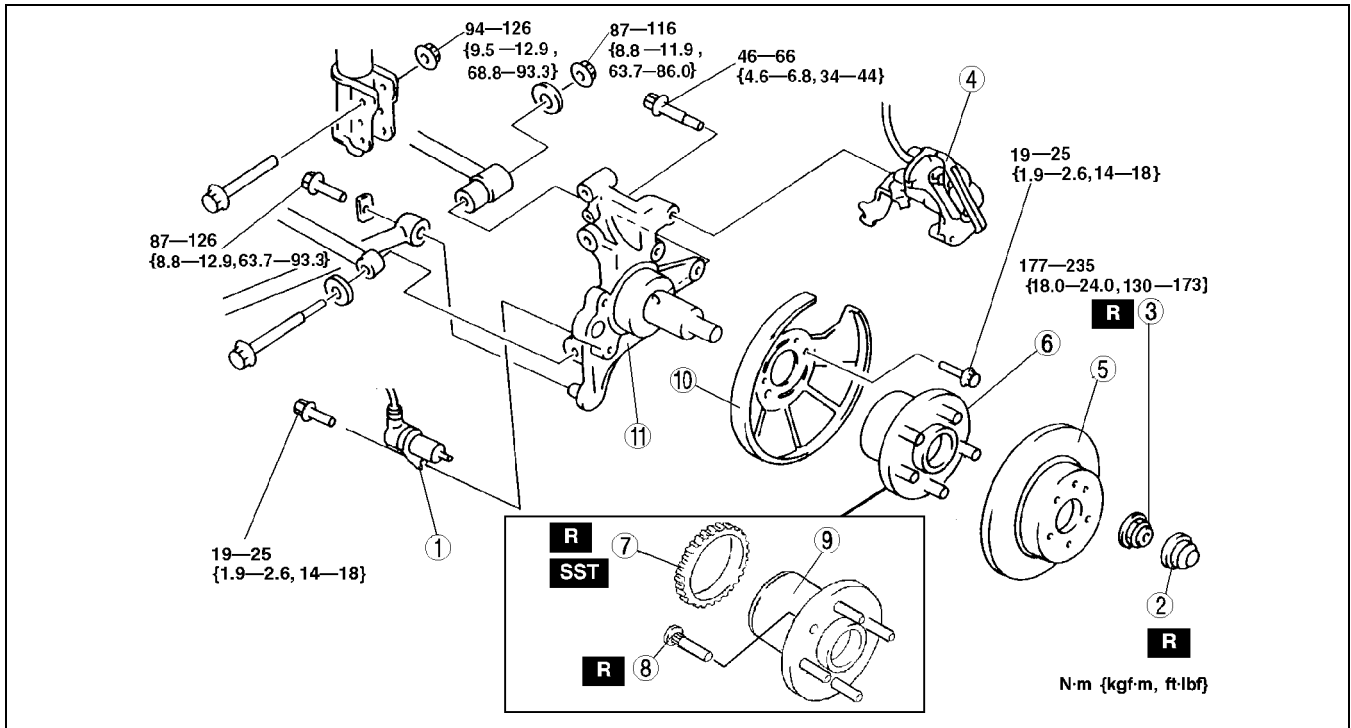

A3U0312W001

1	ABS wheel-speed sensor
2	Hub cap
3	Locknut (See 03-12-2 WHEEL HUB, HUB SPINDLE (DRUM BRAKE TYPE) REMOVAL/INSTALLATION)
4	Brake caliper component
5	Disc plate
6	Wheel hub and ABS sensor rotor

7	ABS sensor rotor (See 03-12-2 WHEEL HUB, HUB SPINDLE (DRUM BRAKE TYPE) REMOVAL/INSTALLATION) (See 03-12-5 ABS Sensor Rotor (With ABS) Installation Note)
8	Hub bolt
9	Wheel hub component
10	Dust cover
11	Hub spindle

REAR AXLE

ABS Sensor Rotor (With ABS) Installation Note

1. Set the **SST** as shown in the figure.

Caution

- Position the **SST** so that marking **B** faces the bottom.

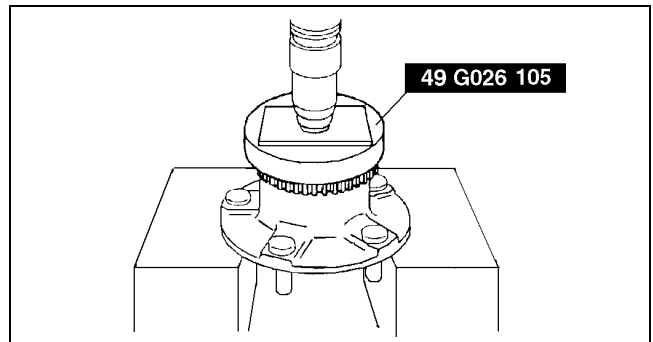

A3U0312W002

03-12

2. Press on the new sensor rotor using the **SST** and a press.

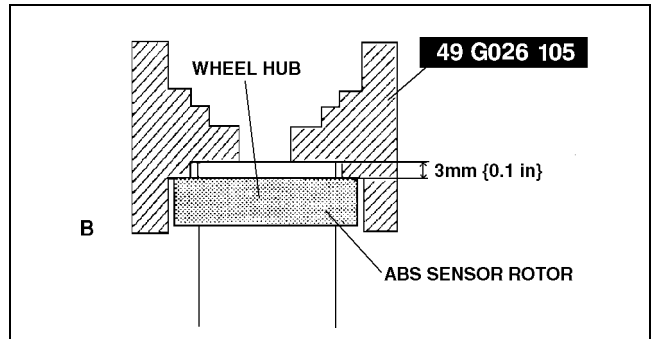

A3U0312W004

03-13 DRIVE SHAFT

DRIVE SHAFT LOCATION INDEX	03-13-2
JOINT SHAFT PRE-INSPECTION	03-13-2
JOINT SHAFT	
REMOVAL/INSTALLATION	03-13-3
Right Drive Shaft and Axle	
Removal Note	03-13-4
Joint Shaft Removal Note	03-13-4
Clip Installation Note	03-13-5
Joint Shaft Installation Note	03-13-5
Right Drive Shaft and Axle	
Installation Note	03-13-5
JOINT SHAFT	
DISASSEMBLY/ASSEMBLY	03-13-6
Joint Shaft Disassembly Note	03-13-6
Bearing Disassembly Note	03-13-6
Dust Seal (right) Assembly Note	03-13-7
Bearing Assembly Note	03-13-7
Dust Seal (left) Assembly Note	03-13-7
Joint Shaft Assembly Note	03-13-8
DRIVE SHAFT PRE-INSPECTION	03-13-8
DRIVE SHAFT	
REMOVAL/INSTALLATION	03-13-9
Drive Shaft Removal Note	03-13-9
Drive Shaft Installation Note	03-13-11
DRIVE SHAFT	
(ZM, FS ATX, FS MTX RIGHT SIDE)	
DISASSEMBLY/ASSEMBLY	03-13-12
Boot Band (Wheel Side)	
Disassembly Note	03-13-12

Boot Band (Transaxle Side)	
Disassembly Note	03-13-13
Outer Ring Disassembly Note	03-13-13
Tripod Joint Disassembly Note	03-13-13
Boot Disassembly Note	03-13-13
ABS Sensor Rotor (With ABS)	
Disassembly Note	03-13-14
ABS Sensor Rotor (With ABS)	
Assembly Note	03-13-14
Dynamic Damper Assembly Note	03-13-14
Boot Assembly Note	03-13-14
Tripod Joint Assembly Note	03-13-15
Outer Ring Assembly Note	03-13-15
Boot Band (Transaxle Side)	
Assembly Note	03-13-16
Boot Band (Wheel Side)	
Assembly Note	03-13-16
DRIVE SHAFT (FS MTX LEFT SIDE)	
DISASSEMBLY/ASSEMBLY	03-13-17
Outer Ring Disassembly Note	03-13-18
Balls, Inner Ring, Cage	
Disassembly Note	03-13-18
Dynamic Damper Assembly Note	03-13-18
Boot Assembly Note	03-13-18
Cage, Inner Ring, Balls, Snap Ring	
Assembly Note	03-13-19
Outer Ring, Clip Assembly Note	03-13-19

03-13

DRIVE SHAFT

DRIVE SHAFT LOCATION INDEX

A3U031325500W01

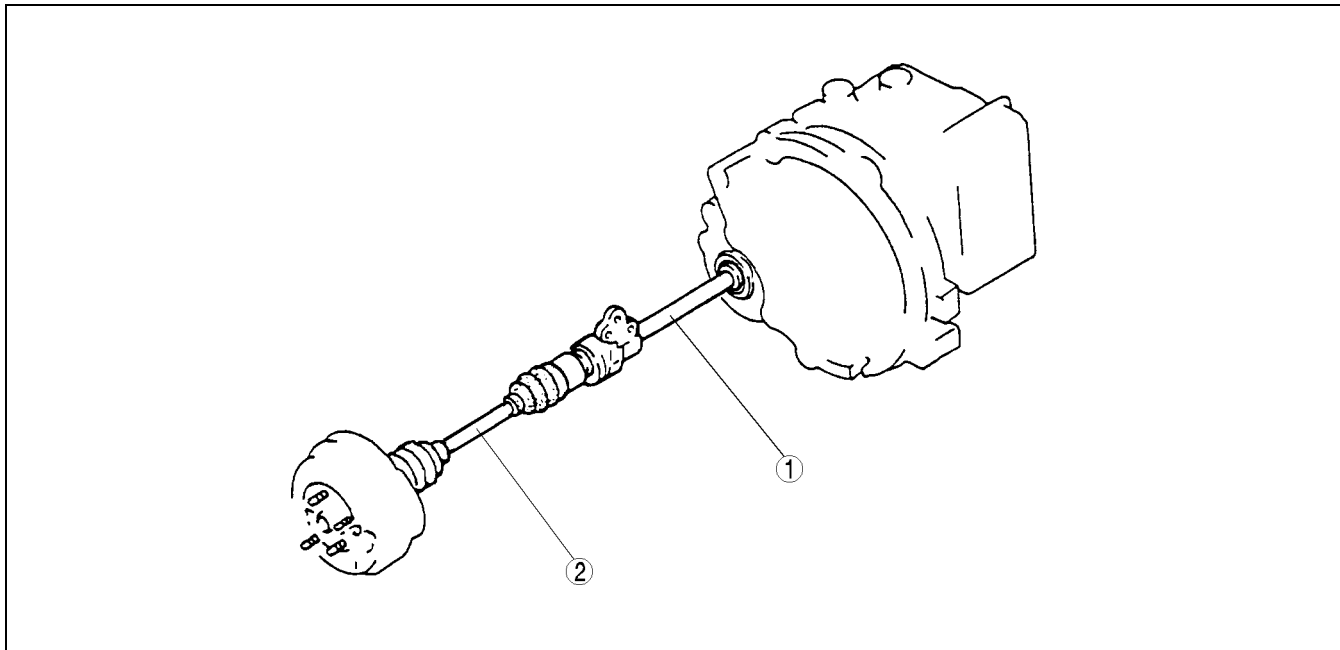

Z3U0313W007

1	Joint shaft (See 03-13-2 JOINT SHAFT PRE-INSPECTION) (See 03-13-3 JOINT SHAFT REMOVAL/ INSTALLATION) (See 03-13-6 JOINT SHAFT DISASSEMBLY/ ASSEMBLY)
---	---

2	Drive shaft (See 03-13-8 DRIVE SHAFT PRE-INSPECTION) (See 03-13-9 DRIVE SHAFT REMOVAL/ INSTALLATION) (See 03-13-12 DRIVE SHAFT (ZM, FS ATX, FS MTX RIGHT SIDE) DISASSEMBLY/ASSEMBLY) (See 03-13-17 DRIVE SHAFT (FS MTX LEFT SIDE) DISASSEMBLY/ASSEMBLY)
---	--

JOINT SHAFT PRE-INSPECTION

A3U031325700W01

1. Verify that the joint shaft is not twisted or cracked.
 - Replace it as necessary.
2. Turn the joint shaft by hand and verify that the bearing rotates smoothly and freely.
 - Replace it as necessary.

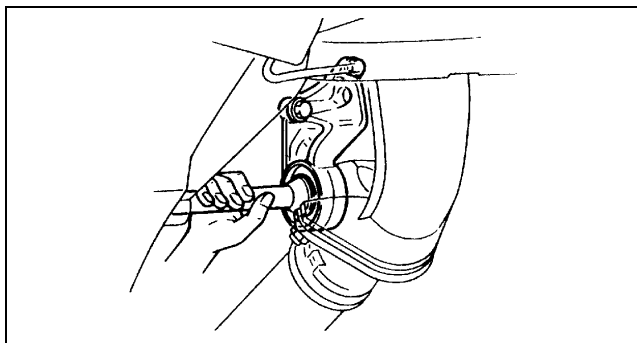

X3U313WA0

DRIVE SHAFT

JOINT SHAFT REMOVAL/INSTALLATION

A3U031325700W02

Caution

- Performing the following procedures without first removing the ABS wheel-speed sensor could cause an open circuit in the harness if it is pulled by mistake. Before performing the following procedures, remove the ABS wheel-speed sensor (axle side) and fix it to an appropriate place where the sensor will not be pulled by mistake while servicing the vehicle.

1. Drain the transaxle oil.
2. Remove in the order indicated in the table.
3. Install in the reverse order of removal.

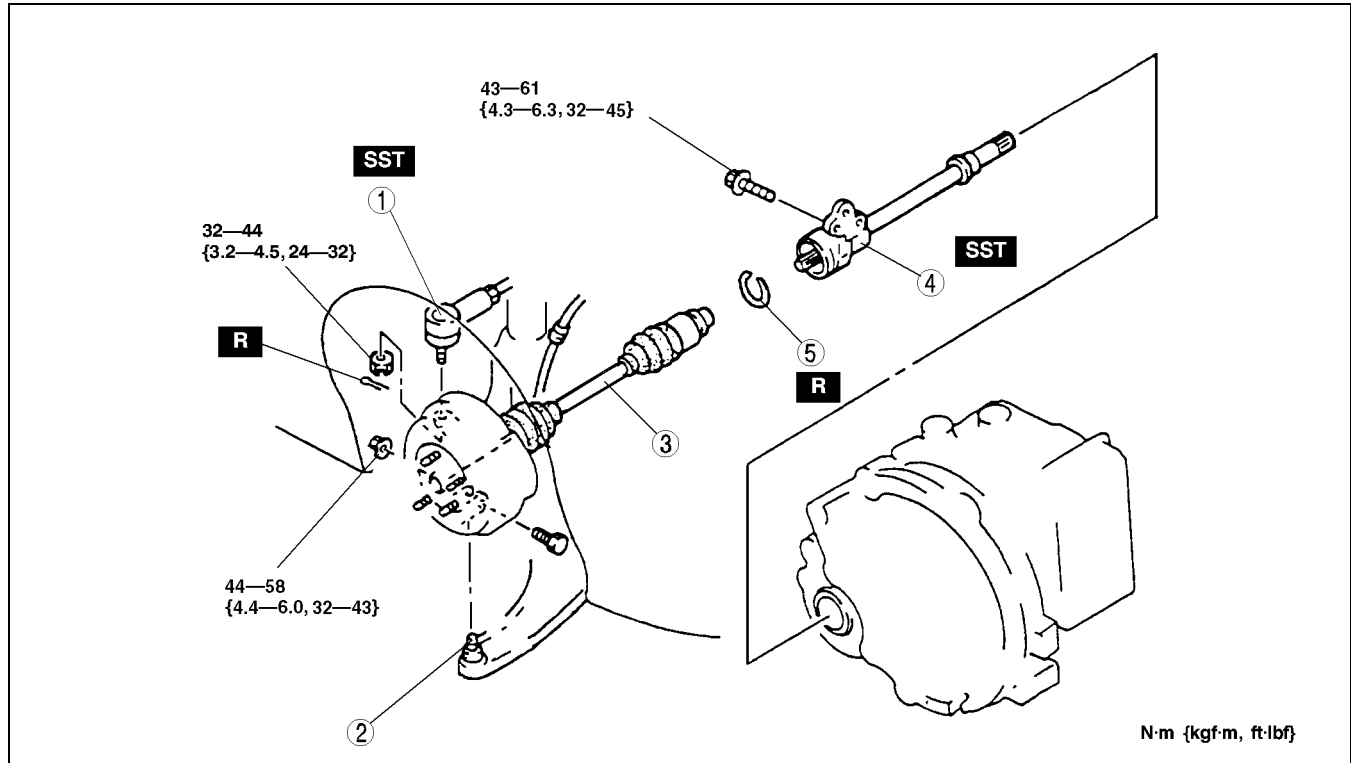

03-13

Y3E6316W001

1	Tie-rod end
2	Lower arm ball joint
3	Right drive shaft and axle (See 03-13-4 Right Drive Shaft and Axle Removal Note) (See 03-13-5 Right Drive Shaft and Axle Installation Note)

4	Joint shaft (See 03-13-4 Joint Shaft Removal Note) (See 03-13-5 Joint Shaft Installation Note)
5	Clip (See 03-13-5 Clip Installation Note)

DRIVE SHAFT

Right Drive Shaft and Axle Removal Note

1. Remove the clinch bolt and nut.
2. Wrap a rag around the ball joint dust boot.
3. Pry the lower arm out of the knuckle.

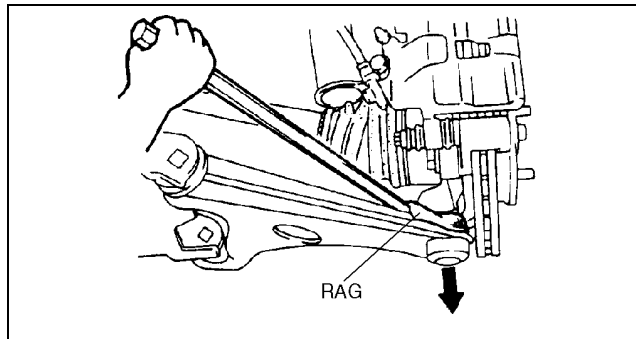

Z3U0312W003

4. As shown in the figure, insert a pry bar between the right drive shaft and the joint shaft and tap on the bar to uncouple them.

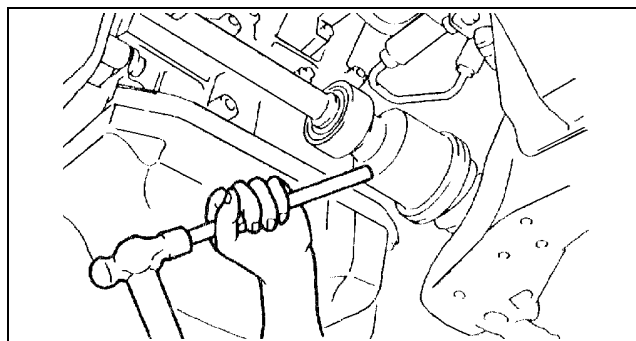

Y3E6316W007

Joint Shaft Removal Note

1. Secure the joint shaft bracket cylinder block.
2. Pull the joint shaft straight out.

Caution

- The sharp edges of the joint shaft can slice or puncture the oil seal. Be careful when installing the joint shaft to the transaxle.

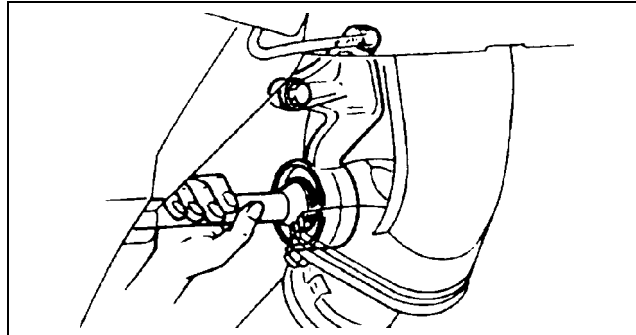

Y3E6316W008

3. Insert the **SST** into the transaxle to hold the side gears after joint shaft removed.

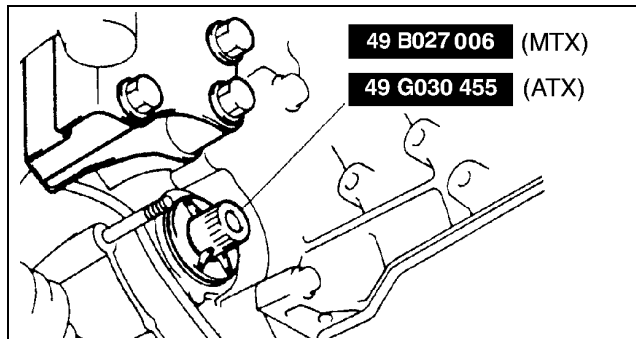

Y3E6316W009

DRIVE SHAFT

Clip Installation Note

1. Install a new clip onto the joint shaft with the opening facing upward. Ensure that the diameter of the clip does not exceed the specification on installation.
2. After installation, measure the outer diameter. If it exceeds the specification, repeat steps 1—2 using a new clip.

Outer diameter specification
30.0 mm {1.18 in}

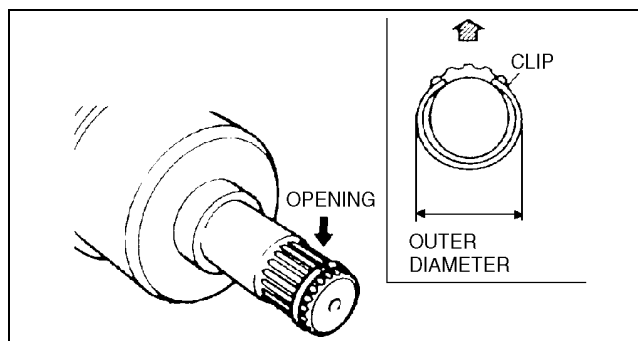

03-13

Joint Shaft Installation Note

1. Install the joint shaft with the end gap of the new clip facing upward.
2. For FS engine, tighten the bolt A, then tighten the bolt B.

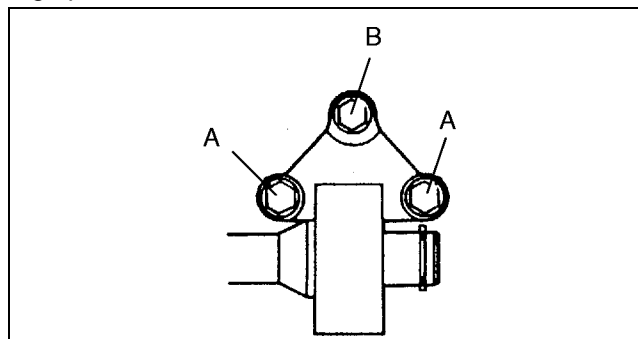

Right Drive Shaft and Axle Installation Note

1. Push the drive shaft into the joint shaft.
2. After installation, pull the transaxle side outer ring forward to verify that the drive shaft is securely held by the clip.
3. Set the lower arm with steering knuckle, then tighten the bolt and nut.

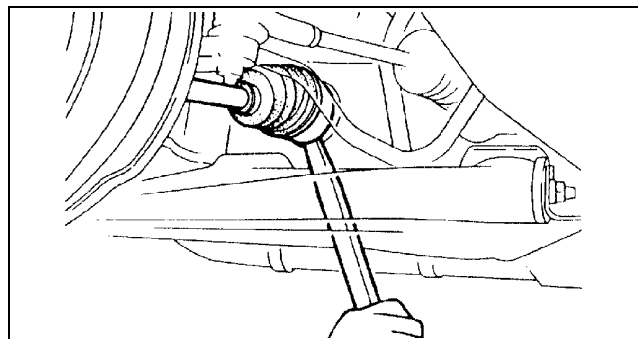

DRIVE SHAFT

JOINT SHAFT DISASSEMBLY/ASSEMBLY

A3U031325700W03

1. Disassemble in the order indicated in the table.
2. Assemble in the reverse order of removal.

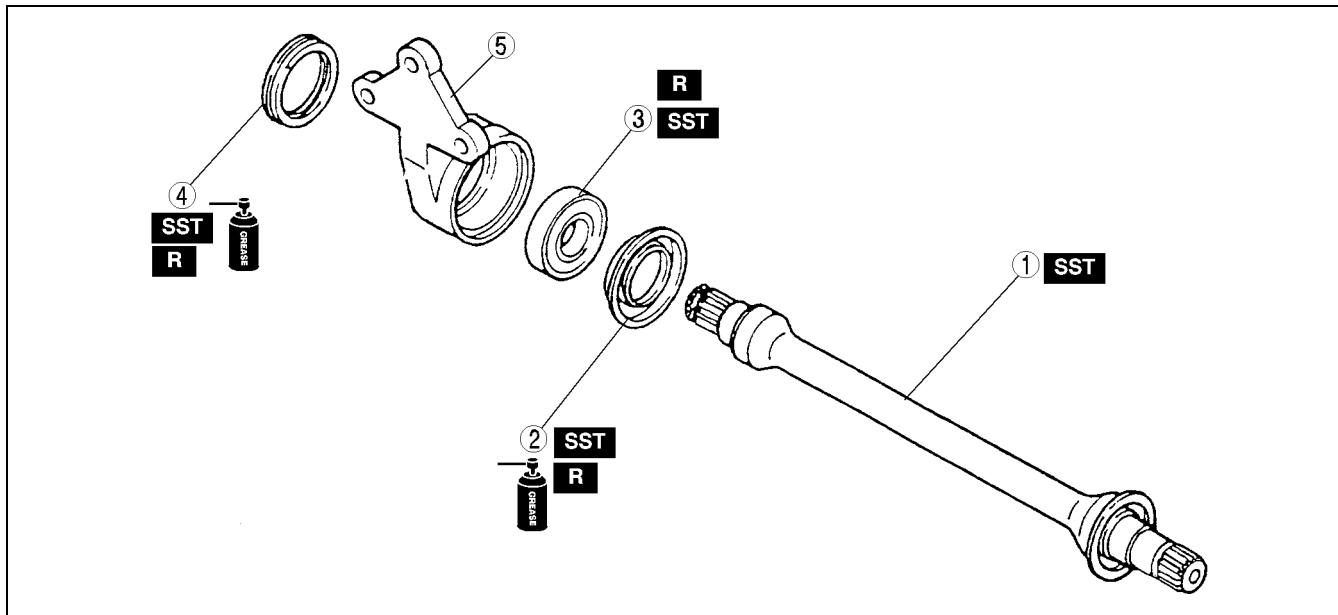

Y3E6316W002

1	Joint shaft (See 03-13-6 Joint Shaft Disassembly Note) (See 03-13-8 Joint Shaft Assembly Note)
2	Dust Seal (left) (See 03-13-7 Dust Seal (left) Assembly Note)

3	Bearing (See 03-13-6 Bearing Disassembly Note) (See 03-13-7 Bearing Assembly Note)
4	Dust Seal (right) (See 03-13-7 Dust Seal (right) Assembly Note)
5	Bracket

Joint Shaft Disassembly Note

1. Disassemble the joint shaft using the SST.

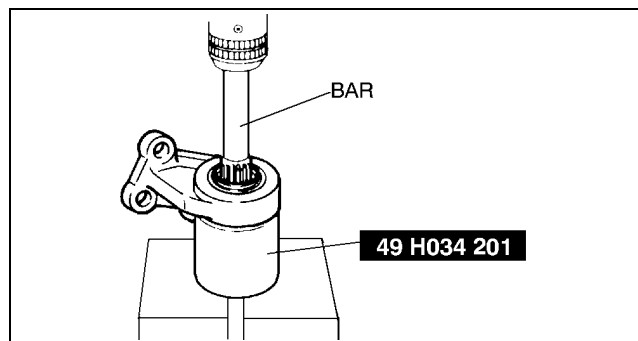

A3U0313W002

Bearing Disassembly Note (If the bearing remains on the bracket)

1. Remove the bearing using the SST.

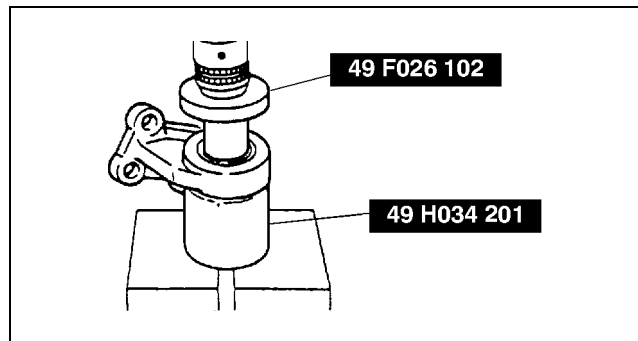

Y3E6316W014

DRIVE SHAFT

(If the bearing remains on the joint shaft)

1. While holding the joint shaft, press out the bearing using the **SST**.

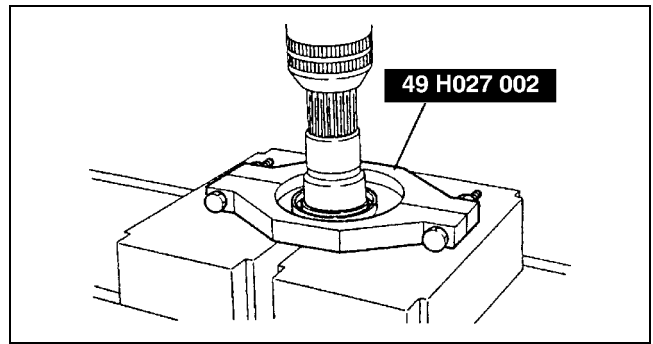

Y3E6316W015

03-13

Dust Seal (right) Assembly Note

1. Apply grease to a new dust seal lip.
2. Install the new right side dust seal using the **SSTs**.

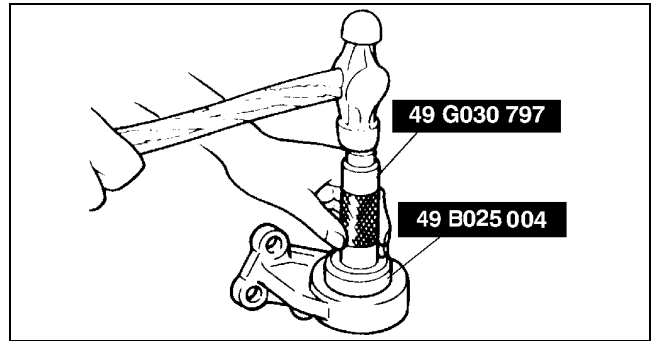

Y3E6316W016

Bearing Assembly Note

1. Install the new bearing using the **SSTs**.

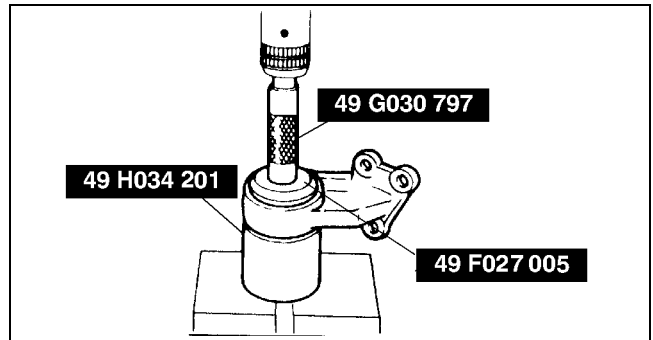

Y3E6316W017

Dust Seal (left) Assembly Note

1. Apply grease to a new dust seal lip.
2. Install the new left side dust seal using a steel plate and the **SSTs**.

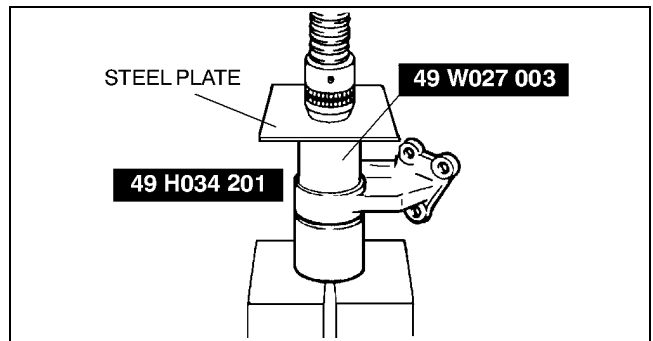

A3U0313W003

DRIVE SHAFT

Joint Shaft Assembly Note

1. Assemble the joint shaft using a press and the **SSTs**

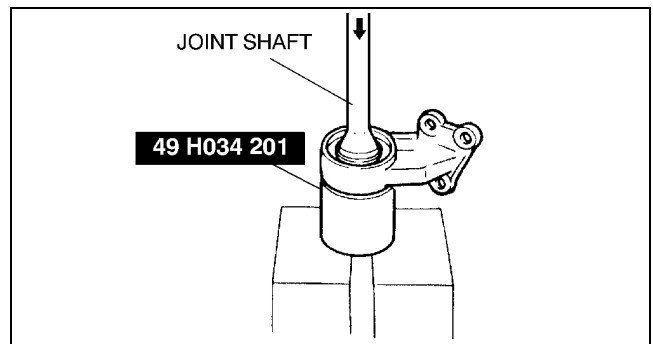

Y3E6316W019

DRIVE SHAFT PRE-INSPECTION

1. Inspect the dust boot on the drive shaft for cracks, damage, leaking grease, and looseness in the boot band.
2. Inspect the drive shaft for bends, cracks, and wear in the joint or splines.
 - Repair or replace the drive shaft or boot/band as necessary.

A3U031325500W02

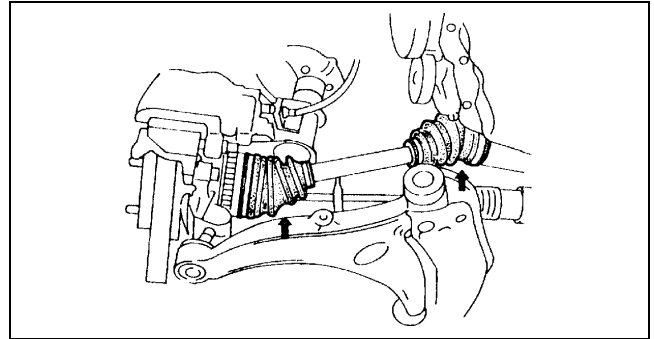

X3U313WAH

DRIVE SHAFT

DRIVE SHAFT REMOVAL/INSTALLATION

A3U03132550W03

Caution

- Performing the following procedures without first removing the ABS wheel-speed sensor may possibly cause an open circuit in the harness if it is pulled by mistake. Before performing the following procedures, remove the ABS wheel-speed sensor (axle side) and fix it to an appropriate place where the sensor will not be pulled by mistake while servicing the vehicle.

1. Drain the transaxle oil.
2. Remove the splash shield.
3. Remove in the order indicated in the table.
4. Install in the reverse order of removal.

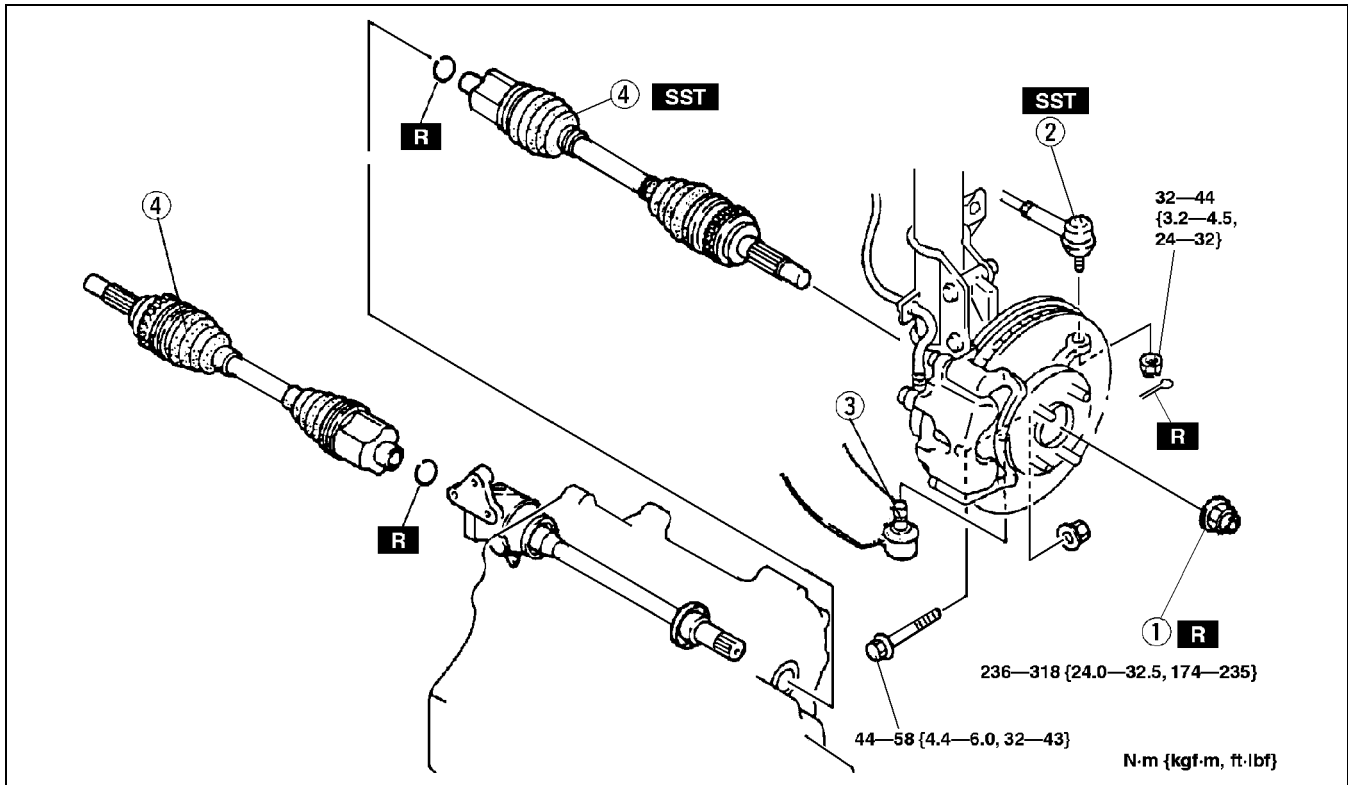

A3U0313W001

1	Locknut
2	Tie-rod end
3	Lower arm ball joint

4	Drive shaft (See 03-13-9 Drive Shaft Removal Note) (See 03-13-11 Drive Shaft Installation Note)
---	---

Drive Shaft Removal Note

1. Remove the clinch bolt and nut.
2. Wrap a rag around the ball joint dust boot.
3. Pry the lower arm out of the knuckle.
4. Install a spare nut onto the drive shaft so that the nut is flush with the end of the drive shaft.
5. Tap the nut with a copper hammer to loosen the drive shaft from the front wheel hub.

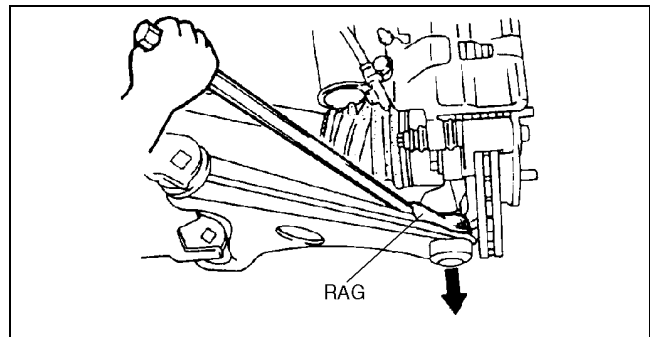

Z3U0312W003

03-13

DRIVE SHAFT

6. Separate the drive shaft from the wheel hub.

Caution

- The sharp edges of the drive shaft can slice or puncture the oil seal. Be careful when removing the drive shaft from the transaxle.

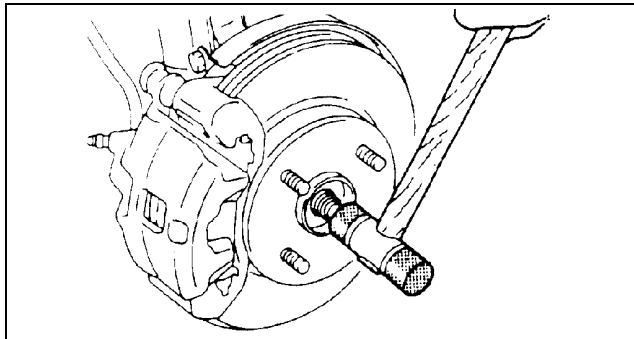

Y3E6316W020

7. Separate the left side drive shaft from the transaxle by prying with a bar inserted between the outer ring and the transaxle, as shown in the figure.

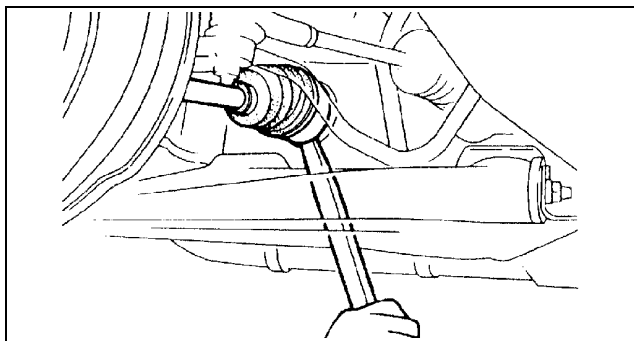

Y3E6316W021

8. Separate the right side drive shaft from the joint shaft by hammering on a bar inserted between them.

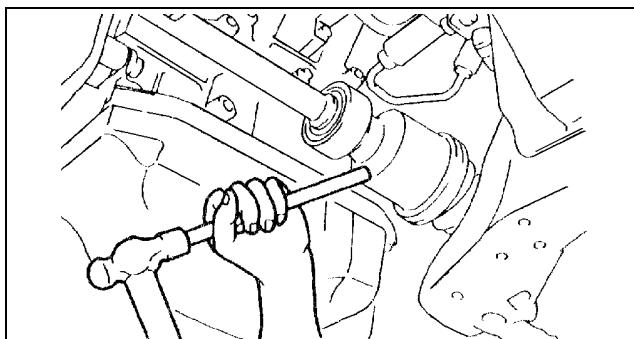

Y3E6316W007

9. Install the **SST** into the transaxle to hold the side gears after drive shaft is removed.

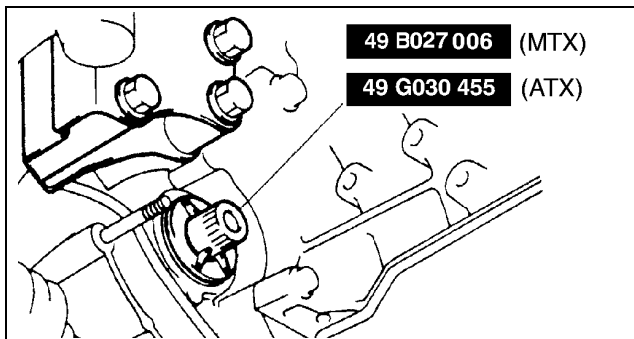

Y3E6316W009

DRIVE SHAFT

Drive Shaft Installation Note

(Left side)

1. Install a new clip onto the drive shaft with the opening facing upward. Ensure that the diameter of the clip does not exceed the specification on installation.
2. After installation, measure the outer diameter.
 - If it exceeds the specification, repeat Steps 1—2 using a new clip.

Outer diameter specification

mm {in}

Engine	Outer diameter
ZM (MTX)	27.2 {1.03}
ZM (ATX)	29.2 {1.15}
FS (MTX)	30.5 {1.20}
FS (ATX)	29.2 {1.15}

Caution

- The sharp edges of the drive shaft can slice or puncture the oil seal. Be careful when installing the drive shaft to the transaxle.
- The oil seals are damaged easily if this procedure is not done correctly.

3. Insert the drive shaft into the wheel hub.
4. Apply ATF to the oil seal lip.

5. Push the drive shaft into the transaxle.
6. After installation, pull the transaxle side outer ring forward to confirm that the drive shaft is securely held by the clip.

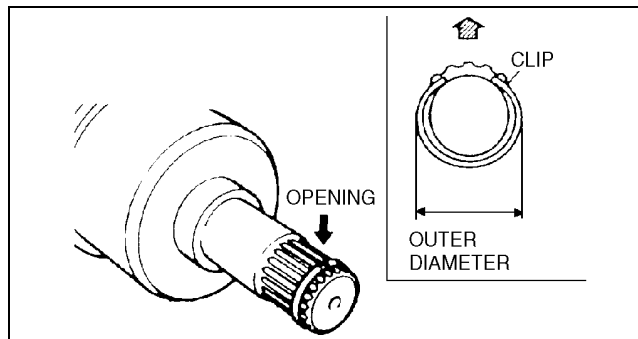

Z3U0312W004

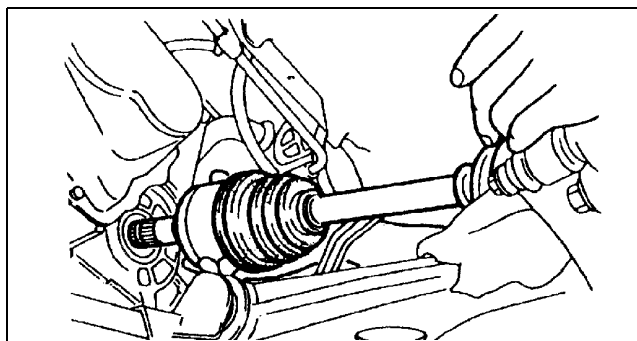

Y3E6316W023

(Right side)

1. Install the joint shaft with the end-gap of a new clip facing upward.
2. Install the drive shaft into the wheel hub.
3. Push the drive shaft into the joint shaft.
4. After installation, pull the transaxle side outer ring forward to confirm that the drive shaft is securely held by the clip.

DRIVE SHAFT

DRIVE SHAFT (ZM, FS ATX, FS MTX RIGHT SIDE) DISASSEMBLY/ASSEMBLY

A3U031325500W04

1. Disassemble in the order indicated in the table.
2. Assemble in the reverse order of disassembly.

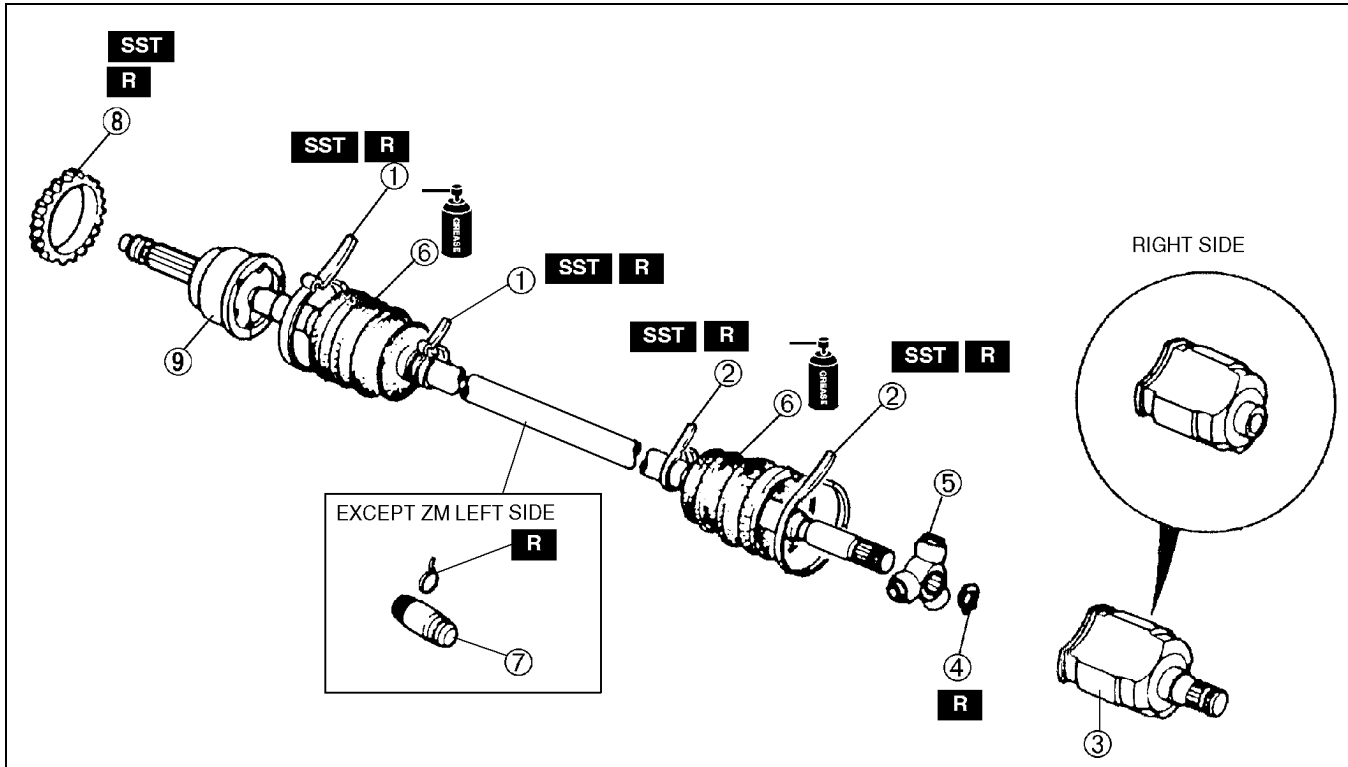

A3U0313W004

1	Boot band (wheel side) (See 03-13-12 Boot Band (Wheel Side) Disassembly Note) (See 03-13-16 Boot Band (Wheel Side) Assembly Note)
2	Boot band (transaxle side) (See 03-13-13 Boot Band (Transaxle Side) Disassembly Note) (See 03-13-16 Boot Band (Transaxle Side) Assembly Note)
3	Outer ring (See 03-13-13 Outer Ring Disassembly Note) (See 03-13-15 Outer Ring Assembly Note)
4	Snap ring

5	Tripod joint (See 03-13-13 Tripod Joint Disassembly Note) (See 03-13-15 Tripod Joint Assembly Note)
6	Boot (See 03-13-13 Boot Disassembly Note) (See 03-13-14 Boot Assembly Note)
7	Dynamic Damper (See 03-13-14 Dynamic Damper Assembly Note)
8	ABS sensor rotor (with ABS) (See 03-13-14 ABS Sensor Rotor (With ABS) Disassembly Note) (See 03-13-14 ABS Sensor Rotor (With ABS) Assembly Note)
9	Shaft and ball joint component

Boot Band (Wheel Side) Disassembly Note

Note

- Thoot band need not to be replaced if removed.

1. Remove the boot clamp with end clamp pliers as shown and discard the clamp.

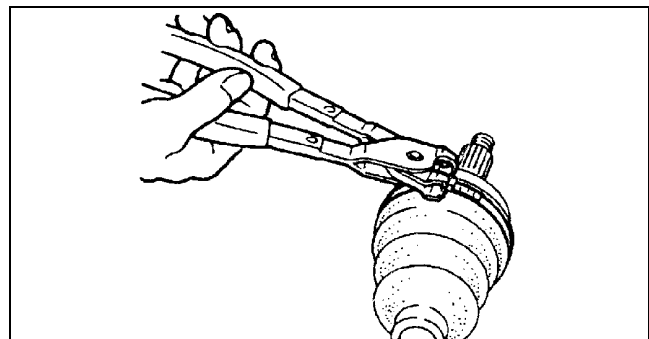

Y3E6316W025

DRIVE SHAFT

Boot Band (Transaxle Side) Disassembly Note

1. Pry up the locking clips using a screwdriver.
2. Pull back the end of the band.

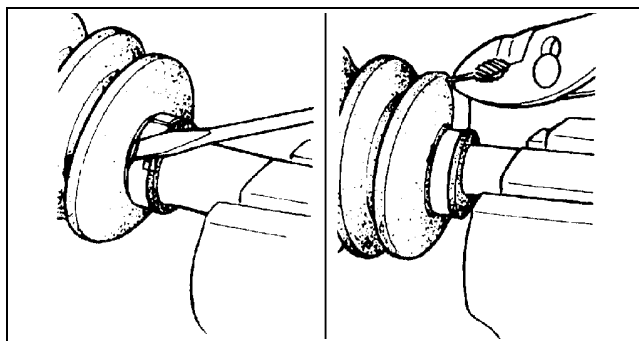

Y3E6316W031

03-13

Outer Ring Disassembly Note

1. Mark the outer ring and the shaft for proper assembly.
2. Remove the outer ring.

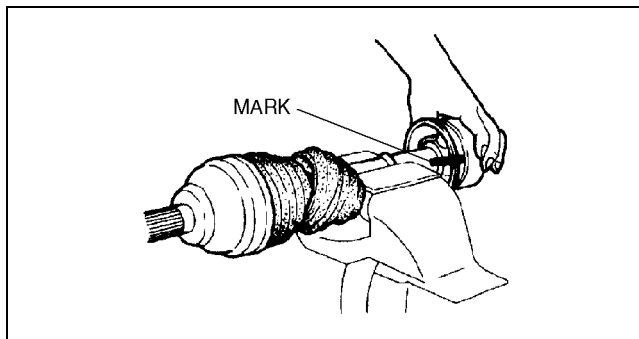

Z3U0313W002

Tripod Joint Disassembly Note

1. Mark the shaft and tripod joint for proper assembly.
2. Remove the snap ring using snap-ring pliers.
3. Remove the tripod joint from the shaft.

Caution

- Do not use a hammer to remove the joint shaft.

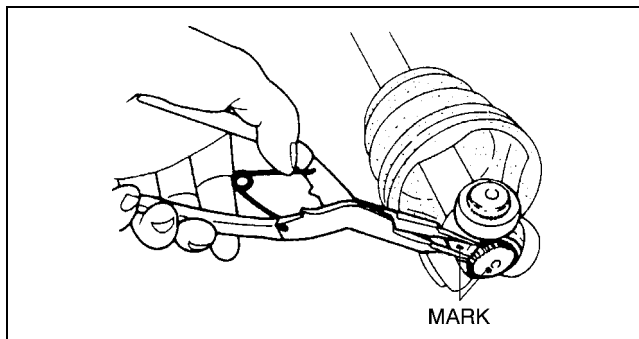

YDE6316W002

Boot Disassembly Note

Note

- The wheel side boot does not need to be removed unless replacing the boot or the ball joint and shaft component.
- Do not strip the tape until the boot is assembled.

1. Wrap the shaft splines with tape.
2. Remove the boot.

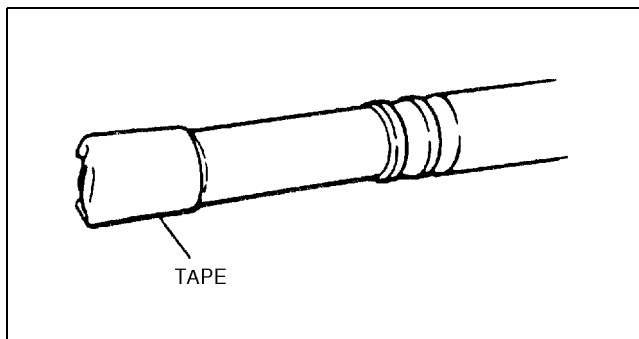

Z3U0313W003

DRIVE SHAFT

ABS Sensor Rotor (With ABS) Disassembly Note

Caution

- Do not remove the sensor rotor unless it is necessary.
- Do not reuse the sensor rotor if removed.

1. Tap the ABS sensor rotor off the drive shaft using a chisel.

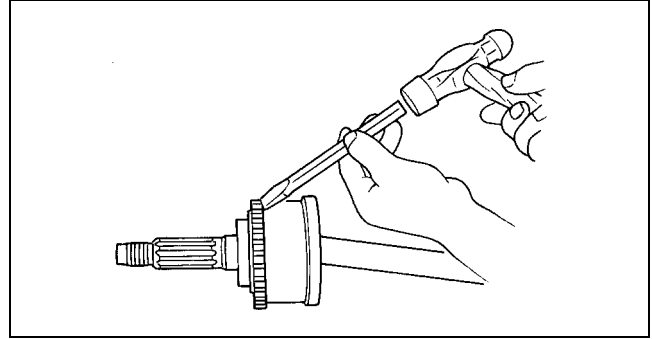

ZLU0313W105

ABS Sensor Rotor (With ABS) Assembly Note

1. Set a new ABS sensor rotor on the drive shaft and press it on using the SSTs.

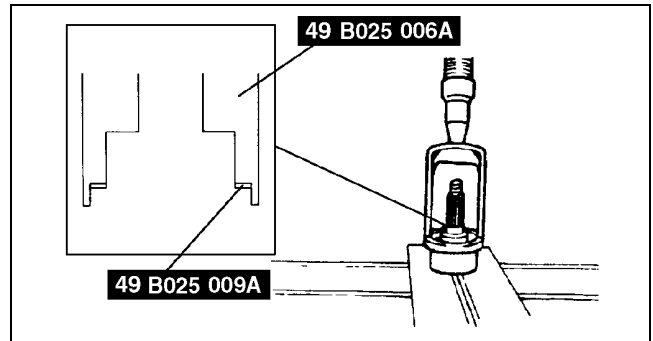

Z3U0313W004

Dynamic Damper Assembly Note

1. Install the dynamic damper as shown in the figure.

Standard length

292—298 mm {11.5—11.7 in}

2. Install the new boot band onto the dynamic damper.

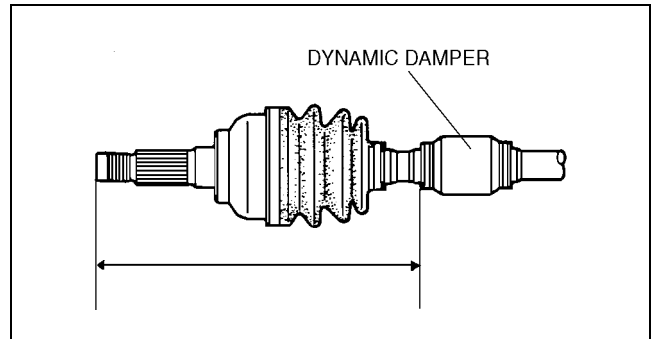

ZLU0313W141

Boot Assembly Note

1. Fill the boot (wheel side) with the specified grease .

Caution

- Do not touch grease with your hand. Apply it from the tube to prevent foreign matter from entering the boot.

Note

- The wheel side and transaxle side boots are different.
- Use the specified grease supplied in the boot kit.

Grease amount

ZM: 60—80 g {2.12—2.82 oz}

FS: 75—95 g {2.65—3.35 oz}

DRIVE SHAFT

2. Install the boot with the splines of the shaft still wrapped in tape from disassembly.
3. Remove the tape.

Tripod Joint Assembly Note

1. Align the marks and install the tripod joint using a bar and a hammer.

Caution

- Do not damage the roller.

2. Install the new snap ring using a snap-ring pliers.

Caution

- Install the snap ring in the shaft groove securely.

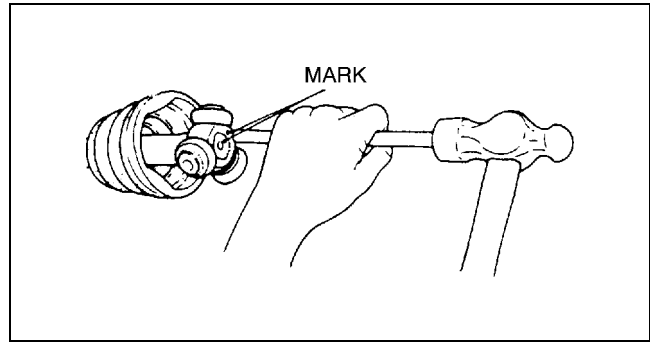

YDE6316W006

03-13

Outer Ring Assembly Note

1. Fill the outer ring and boot (transaxle side) with the specified grease from a tube, not by hand.

Caution

- Do not touch grease with your hand. Apply it from the tube to prevent foreign matter from entering the boot.

Note

- Use the specified grease supplied in the boot kit.

Grease amount

115—135 g {4.06—4.76 oz}

2. Install the outer ring.
3. Set the drive shaft to the standard length.

Standard length

mm {in}

Engine	Left side	Right side
ZM (MTX)	642.6—652.6 {25.30—25.69}	607.9—617.9 {23.94—24.32}
ZM (ATX)	626.7—636.7 {24.68—25.06}	
FS (MTX)	—	604.6—614.6 {23.81—24.19}
FS (ATX)	627.9—637.9 {24.73—25.11}	608.9—618.9 {23.98—24.36}

4. Release any trapped air from the boots by carefully lifting up the small end of each boot with a cloth wrapped screwdriver.

Caution

- Be careful not to allow the grease to leak.
- Do not damage the boot.

5. Verify that the drive shaft length is within the specification.

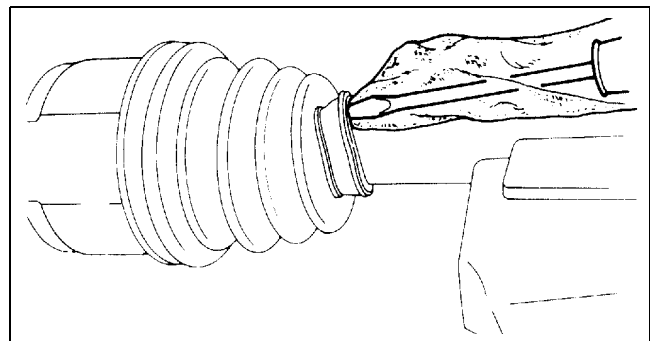

Y3E6316W033

DRIVE SHAFT

Boot Band (Transaxle Side) Assembly Note

1. Fold the band back and use pliers to pull it tight.

Note

- Always use new bands.
- The band should be folded in the direction opposite to the forward revolving direction of the drive shaft.

2. Lock the end of the band by bending the locking clips.

Caution

- Verify that the boot band is installed in the boot groove securely.

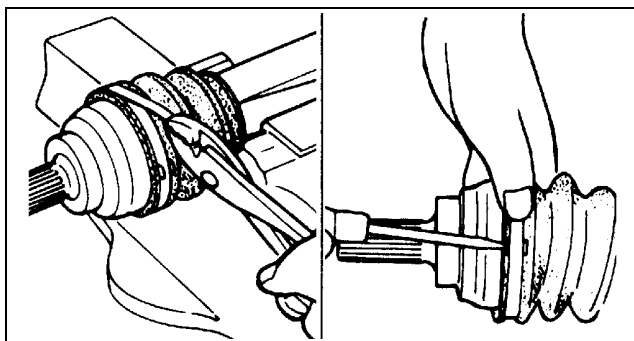

Y3E6316W035

Boot Band (Wheel Side) Assembly Note

1. Adjust clearance A by turning the adjusting bolt of the SST.

Clearance A

2.9 mm {0.11 in}

2. Crimp the wheel side small boot band using the SST. Verify that clearance B is within the specification.
 - If clearance B is more than the specification, reduce clearance A of the SST and crimp the boot again.
 - If clearance B is less than the specification, replace the boot band, increase clearance A of the SST, and crimp the new boot.

Clearance B

2.4—2.8 mm {0.095—0.110 in}

3. Verify that the boot band does not protrude from the boot band installation area.
 - If it does, replace the boot band and repeat from Step 1.
4. Fill the boot with the repair kit grease.
5. Adjust clearance A by turning the adjusting bolt of the SST.

Clearance A

3.2 mm {0.13 in}

6. Crimp the wheel side big boot band using the SST.
7. Verify that clearance B is within the specification.
 - If clearance B is more than the specification, reduce clearance A of the SST and crimp the boot again.
 - If clearance B is less than the specification, replace the boot band, increase clearance A of the SST and crimp the new boot.

Clearance B

2.4—2.8 mm {0.095—0.110 in}

8. Verify that the boot band does not protrude from the boot band installation area.
 - If it does, replace the boot band and repeat from Steps 5.

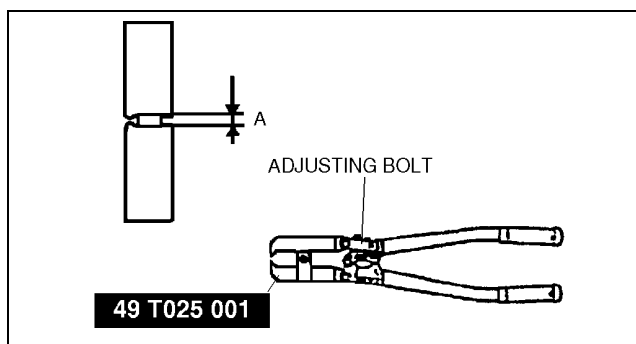

Z3U0313W009

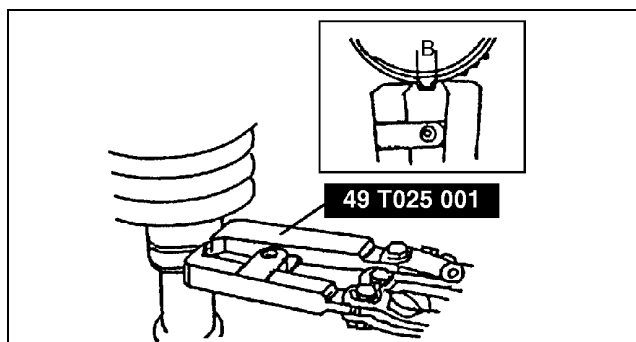

Y3E6316W028

DRIVE SHAFT

DRIVE SHAFT (FS MTX LEFT SIDE) DISASSEMBLY/ASSEMBLY

A3U03132550W05

1. Disassemble in the order indicated in the table.
2. Assemble in the reverse order of disassembly.

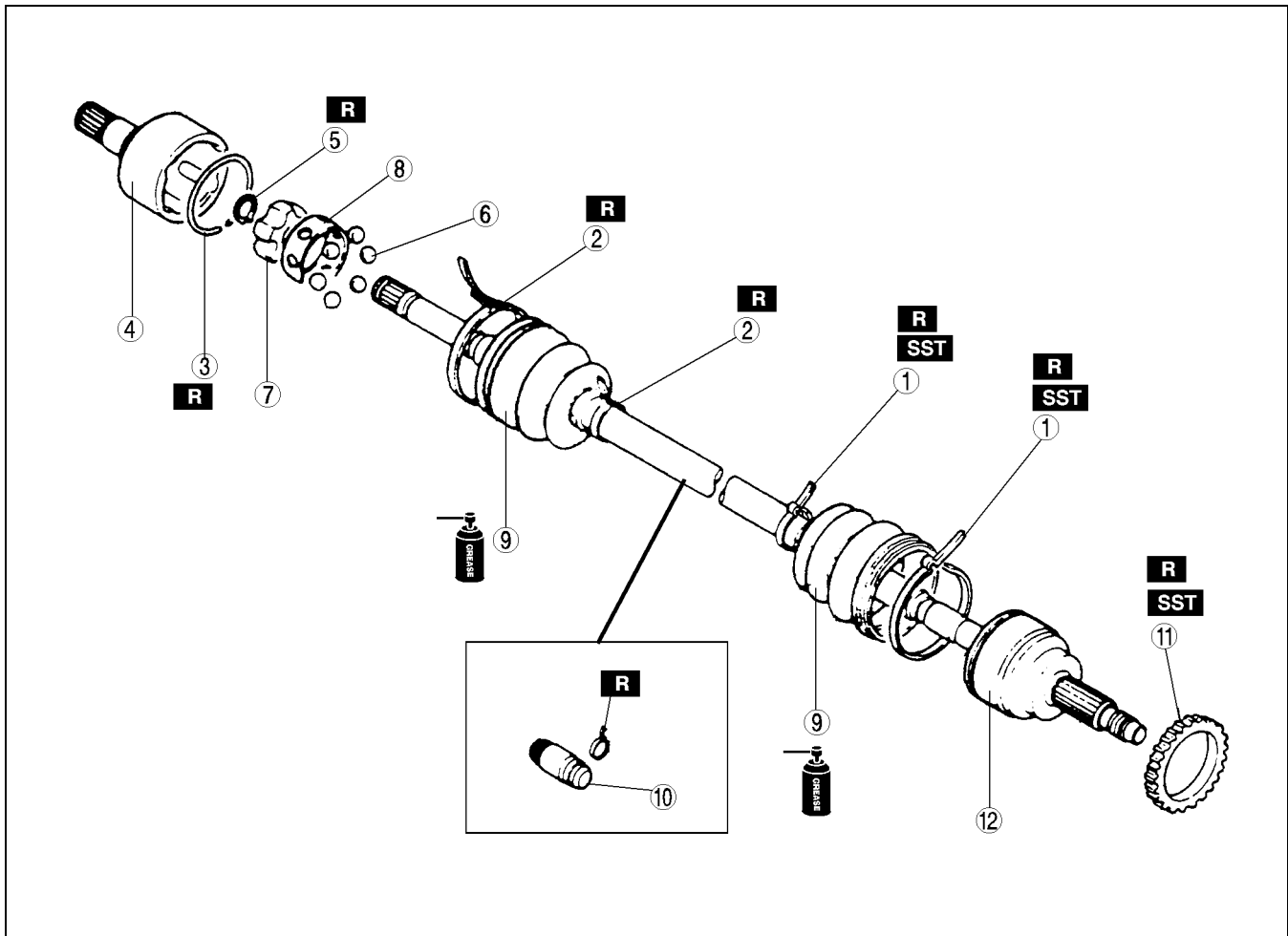

03-13

A3U0313W005

1	Boot band (wheel side) (See 03-13-12 DRIVE SHAFT (ZM, FS ATX, FS MTX RIGHT SIDE) DISASSEMBLY/ASSEMBLY)
2	Boot band (transaxle side) (See 03-13-12 DRIVE SHAFT (ZM, FS ATX, FS MTX RIGHT SIDE) DISASSEMBLY/ASSEMBLY)
3	Clip (See 03-13-18 Outer Ring Disassembly Note) (See 03-13-19 Outer Ring, Clip Assembly Note).
4	Outer ring (See 03-13-19 Outer Ring, Clip Assembly Note)
5	Snap ring (See 03-13-19 Cage, Inner Ring, Balls, Snap Ring Assembly Note)
6	Balls (See 03-13-18 Balls, Inner Ring, Cage Disassembly Note) (See 03-13-19 Cage, Inner Ring, Balls, Snap Ring Assembly Note)

7	Inner Ring (See 03-13-18 Balls, Inner Ring, Cage Disassembly Note) (See 03-13-19 Cage, Inner Ring, Balls, Snap Ring Assembly Note)
8	Cage (See 03-13-18 Balls, Inner Ring, Cage Disassembly Note) (See 03-13-19 Cage, Inner Ring, Balls, Snap Ring Assembly Note)
9	Boot (See 03-13-18 Boot Assembly Note)
10	Dynamic damper (See 03-13-18 Dynamic Damper Assembly Note)
11	ABS sensor rotor (See 03-13-12 DRIVE SHAFT (ZM, FS ATX, FS MTX RIGHT SIDE) DISASSEMBLY/ASSEMBLY)
12	Shaft and ball joint component

DRIVE SHAFT

Outer Ring Disassembly Note

1. Mark the drive shaft and outer ring for proper assembly.

Caution

- Mark with paint; do not use a punch.

2. Remove the clip.

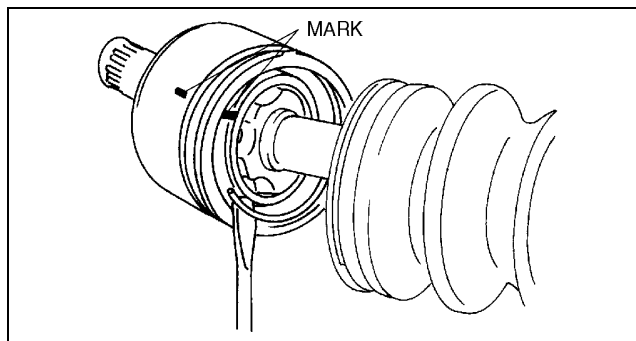

Z3U0313W005

Balls, Inner Ring, Cage Disassembly Note

1. Mark the inner ring and cage.

Caution

- Mark with paint; do not use a punch.

2. Remove the snap ring using snap-ring pliers.
3. Turn the cage approximately 30 degree and pull the cage and balls away from the inner ring.

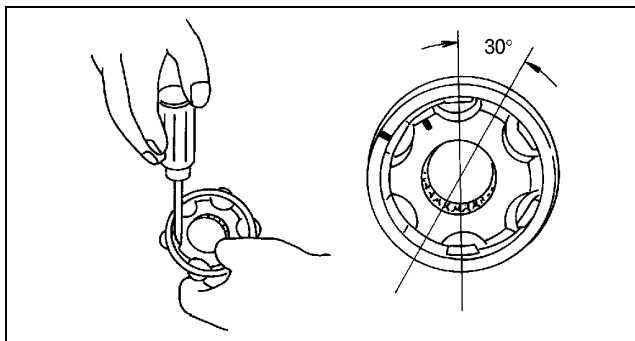

YYJ6316W007

Dynamic Damper Assembly Note

1. Install the dynamic damper as shown in the figure.

Standard length

292—298 mm {11.5—11.7 in}

2. Install the new boot band onto the dynamic damper.

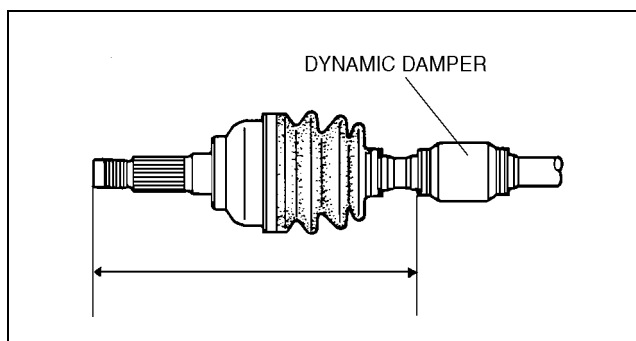

ZLU0313W141

Boot Assembly Note

1. Fill the boot (wheel side) with the specified grease from a tube, not by hand.

Caution

- Do not touch grease with your hand. Apply it from the tube to prevent foreign matter from entering the boot.

Note

- The wheel side and transaxle side boots are different.
- Use the specified grease supplied in the boot kit.

Grease amount

75—95 g {2.65—3.35 oz}

DRIVE SHAFT

2. With the splines of the shaft still wrapped in tape from disassembly, install the boot.
3. Remove the tape.

Cage, Inner Ring, Balls, Snap Ring Assembly Note

1. Align the marks and install the balls and cage to the inner ring in the direction shown in the figure.

Caution

- Install the cage with the offset facing the snap ring groove. If incorrectly installed, the drive shaft may become disengaged.

2. Install a new snap ring.

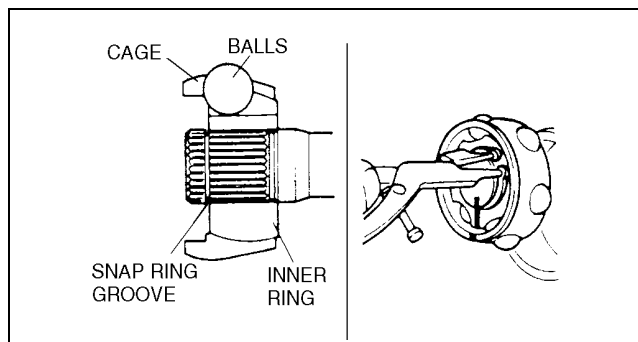

Z3U0313W006

03-13

Outer Ring, Clip Assembly Note

1. Fill the outer ring and boot (transaxle side) with the specified grease.

Caution

- Do not touch grease with your hand. Apply it from the tube to prevent foreign matter from entering the boot.

Note

- Use the specified grease supplied in the boot kit.

Grease amount

95—115 g {3.36—4.05 oz}

2. Align the marks, and install the outer ring on to the shaft.
3. Install a new clip.
4. Install the boot.
5. Set the drive shaft to the standard length.

Standard length

641.0—651.0 {25.24—25.62}

6. Release any trapped air from the boots by carefully lifting up the small end of each boot with a cloth wrapped screwdriver.

Caution

- Be careful not to allow the grease to leak.
- Do not damage the boot.

7. Verify that the drive shaft length is within the specification.

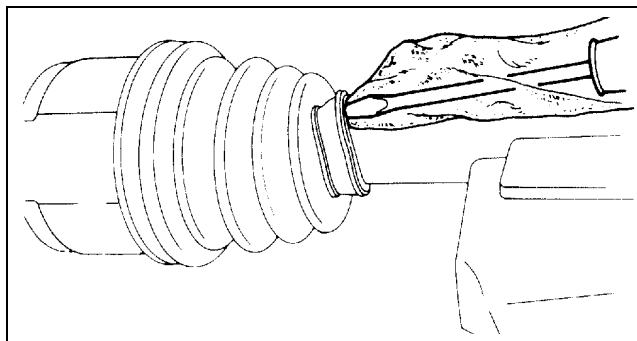

Y3E6316W033

TECHNICAL DATA

03-50 TECHNICAL DATA

DRIVELINE/AXLE TECHNICAL DATA. . 03-50-1

DRIVELINE/AXLE TECHNICAL DATA

A3U035001018W01

Item	ZM		FS			
	MTX	ATX	MTX	ATX		
FRONT AXLE						
Maximum wheel bearing play	(mm {in})	0.05 {0.002}				
REAR AXLE						
Maximum wheel bearing play	(mm {in})	0.05 {0.002}				
DRIVE SHAFT						
Shaft length (Air in boot at atmospheric pressure)	(mm {in})	Left side	642.6—652.6 {25.30—25.69}	626.7—636.7 {24.68—25.06}	641.0—651.0 {25.24—25.62}	627.9—637.9 {24.73—25.11}
		Right side	607.9—617.9 {23.94—24.32}		604.6—614.6 {23.81—24.19}	608.9—618.9 {23.98—24.36}

03-50





SERVICE TOOLS

03-60 SERVICE TOOLS

DRIVELINE/AXLE SST 03-60-1

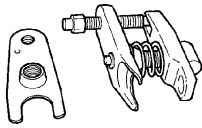
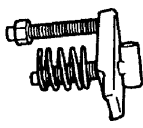
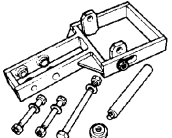
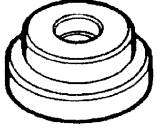
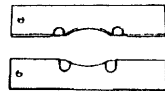
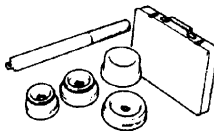
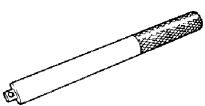
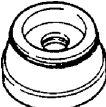

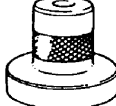
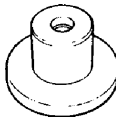
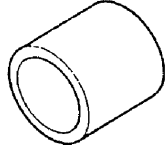
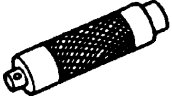

DRIVELINE/AXLE SST

A3U036001018W01

<p>49 T028 3A0</p> <p>Ball joint puller set</p> 	<p>49 T028 303</p> <p>Body (Part of 49 T028 3A0)</p> 	<p>49 T028 304</p> <p>Attachment (Part of 49 T028 3A0)</p> 
<p>49 B026 1A0</p> <p>Wheel hub puller set</p> 	<p>49 G033 102</p> <p>Handle (Part of 49 B026 1A0)</p> 	<p>49 G030 727</p> <p>Attachment (Part of 49 B026 1A0)</p> 
<p>49 F026 103</p> <p>Wheel hub puller</p> 	<p>49 F027 0A1</p> <p>Bearing installer set</p> 	<p>49 F027 003</p> <p>Handle (Part of 49 F027 0A1)</p> 
<p>49 F027 005</p> <p>Attachment ø62 (Part of 49 F027 0A1)</p> 	<p>49 F027 007</p> <p>Attachment ø72 (Part of 49 F027 0A1)</p> 	<p>49 F027 009</p> <p>Attachment ø68 & 77 (Part of 49 F027 0A1)</p> 
<p>49 E033 101</p> <p>Dust cover installer</p> 	<p>49 V001 795</p> <p>Oil seal installer</p> 	<p>49 B026 103</p> <p>Sensor rotor installer</p> 
<p>49 G026 105</p> <p>Sensor rotor installer</p> 	<p>49 F026 102</p> <p>Bearing installer</p> 	<p>49 W027 003</p> <p>Bearing installer</p> 
<p>49 T025 001</p> <p>Boot clamp crimper</p> 	<p>49 G030 797</p> <p>Handle (Part of 49 G030 795)</p> 	<p>49 B025 004</p> <p>Dust boot installer</p> 

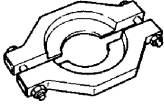
03-60

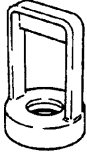
SERVICE TOOLS

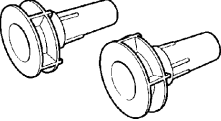
<p>49 H027 002</p> <p>Bearing installer</p> 	<p>49 H034 201</p> <p>Support block</p> 	<p>49 B025 006A</p> <p>Sensor rotor installer</p> 
<p>49 B025 009A</p> <p>Installer attachment</p> 	<p>49 B027 006</p> <p>Diff. side gear holder (MTX)</p> 	<p>49 G030 455</p> <p>Diff. side gear holder (ATX)</p> 